



SCPH-30001D
SCPH-30002D
SPCH-30003D
SPCH-30004D

SCPH30000 series SERVICE MANUAL

3rd edition

for D type MD and CONSOLE structure only

PlayStation®2



Sony Computer Entertainment Inc.
Customer Service Department
Published in Japan c2.2001 9-927-086-03

NOTICE

This service manual published ©2.2001 by Sony Computer Entertainment Inc.. All right received. Reproduction and distribution without the permission of Sony Computer Entertainment Inc. is strictly prohibited. Commercial use or Rental prohibited. This service manual is the proprietary property of Sony Computer Entertainment Inc.. It's use is authorized person who work for PlayStation®2 only.

REVISIONS

Design and Specification are subject to change without notice.

CAUTION

This use of optical instruments with this product will increase eye Hazard. As the laser beam used in this PlayStation®2 is harmful to eyes do not attempt to disassemble the cabinet. Refer servicing to qualified personnel only.

WARNING!!

WHEN SERVICING, DO NOT APPROACH THE LASER EXIT WITH THE EYE TOO CLOSELY. IN CASE IT IS NECESSARY TO CONFIRM LASER BEAM EMISSION, BE SURE TO OBSERVE FROM A DISTANCE OF MORE THAN 25 CM FROM THE SURFACE OF THE OBJECTIVE LENS ON THE OPTICAL PICK-UP BLOCK.

CAUTION for electric shock

When power is ON, Don't touch to Power block, AC-inlet, Power switch and so on, not to get an electric shock at repair.

CAUTION for burning

When current is supplied, Some of part surface temperature like EE, GS, Regulator-IC, Power supply, Optical device and so on. These part surface is become high temperature condition. When it repair, Don't touch them at a time during it surface is high temperature condition to take prevent against burning. Do repair after it is cooled down enough.

NOTIFICATION for environmental assessment

This model is CR2032 lithium battery on board inside on the GB003 as timer back-up power. CR2032 life may be about 5-8 years so you have very few need for changing to new one. But if you have necessary to new one or disassemble for scrapping, you have to keep your to country low, regulation, standard, etc. of environmentl assess-ment and safety.

CAUTION

Danger of explosion if battery is incorrectly replaced. Replace only with the same or equivalent type recommended by the manufacturer. Discard used batteries according to the manufacturer's instruction.

ADVARSEL!

Lithiumbatteri-Eksplosionsfare ved fejlagtig håndtering. Udskiftning må kun ske med batteri af samme fabrikat og type. levér det brugte batteri tilbage til leverandøren.

ADVARSEL

Eksplosjonsfare ved feilaktig skifte av batteri. Benytt samme batteritype eller en tilsvarende type anbefalt av apparatfabrikanten. Brukte batterier kasseres i henhold til fabrikantens instruksjoner.

VARNING

Explosionsfara vid felaktigt batteribyte. använt samme batterityp eller en ekvivalent typ som rekommenderas av apparattillverkaren. Kassera använt batteri enligt fabrikantens instruktion.

VAROITUS

Paristo voi räjähtää, jos se on virheellisesti asennettu. Vaihda paristo ainoastaan valmistajan suosittelemaan tyyppiin. Hävitä käytetty paristo valmistajan ohjeiden mukaisesti.

Table of contents

• CONSOLE	3
• MD BLOCK	23

CAUTION for static electricity

For disassemble and assemble the console, Don' t charge static electricity on your body and around equipment. Get rid static electricity by grounding your body and around equipment.

Static electricity will be destroyed key devives like ICs, OPT and etc.

71 LABEL, MODEL NUMBER

112 TAPE, VOID

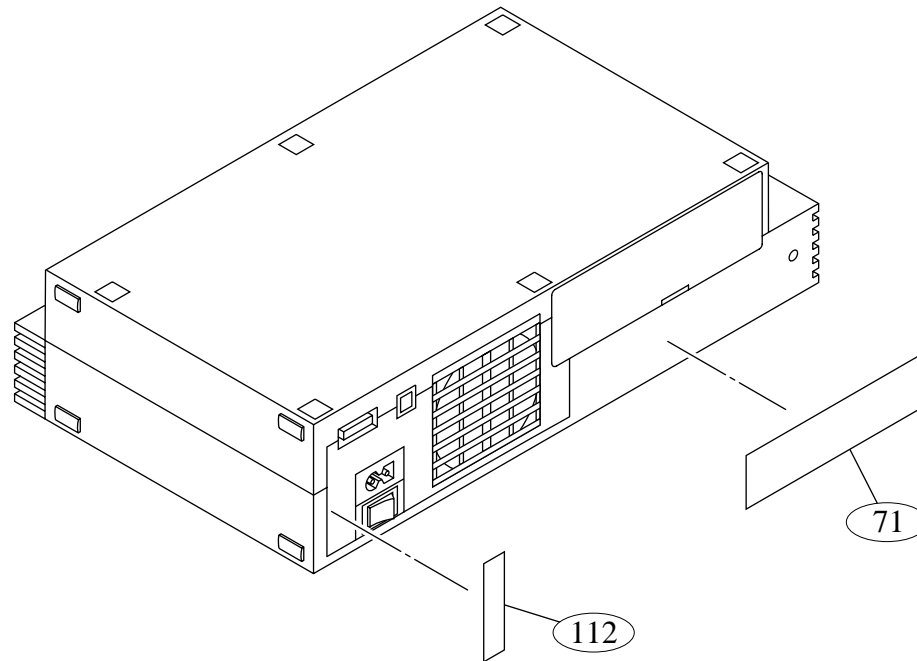

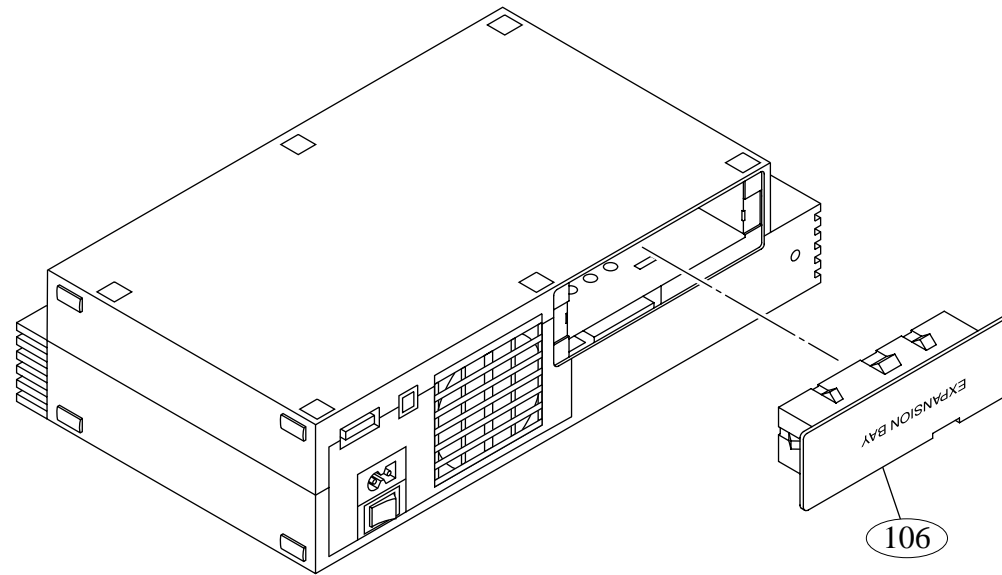

CAUTION

When tighten the BV316 and M354 screws,
Tighten them in order to the steps shown figure.

75 COVER, SCREW

76 CAP

BV316 SCREW (2 LOCK),
+BV TAPPING

M354 SCREW (M3 X 54),
HEAD TAPPING

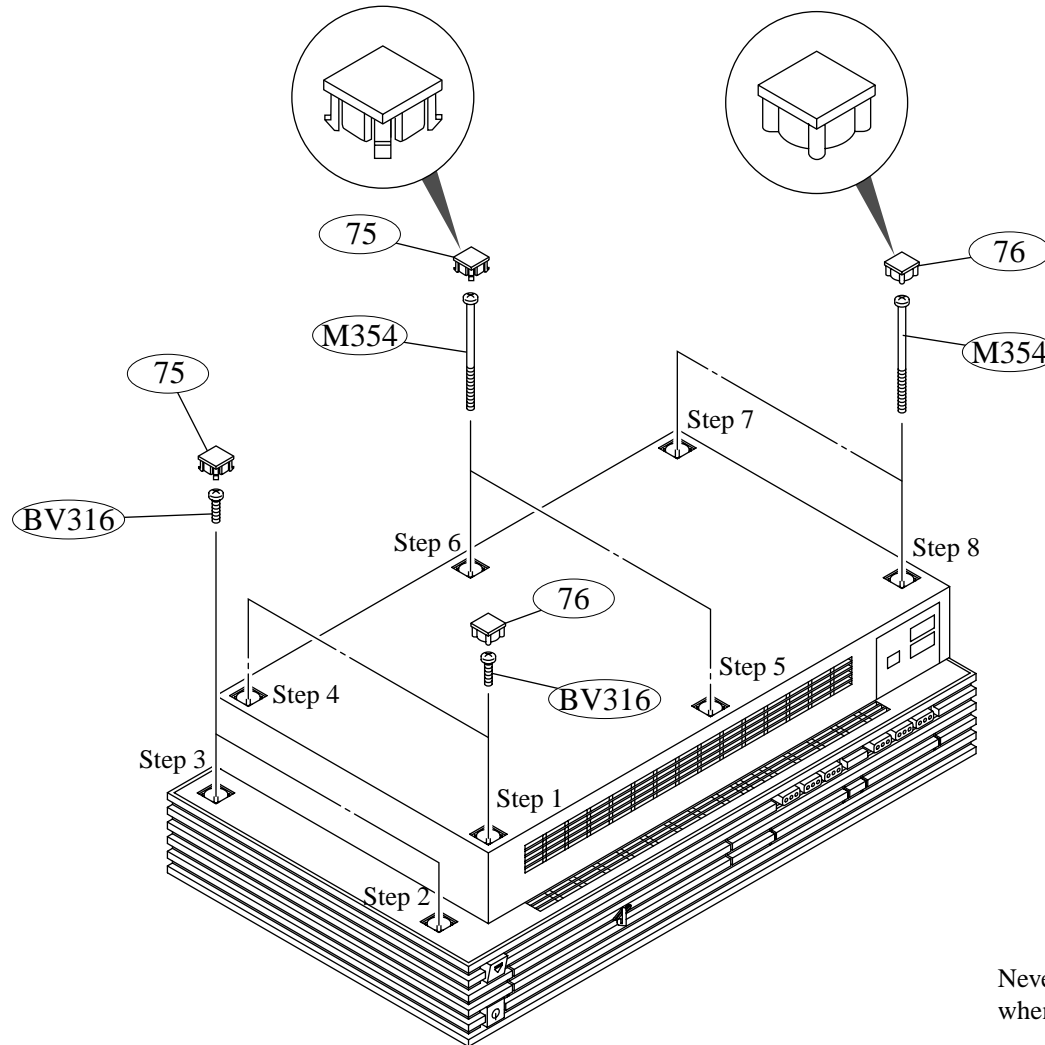

Never scratch for CAPS and SCREW COVERS
when removing them.

TOOLS : SCREW DRIVER (+ #3)

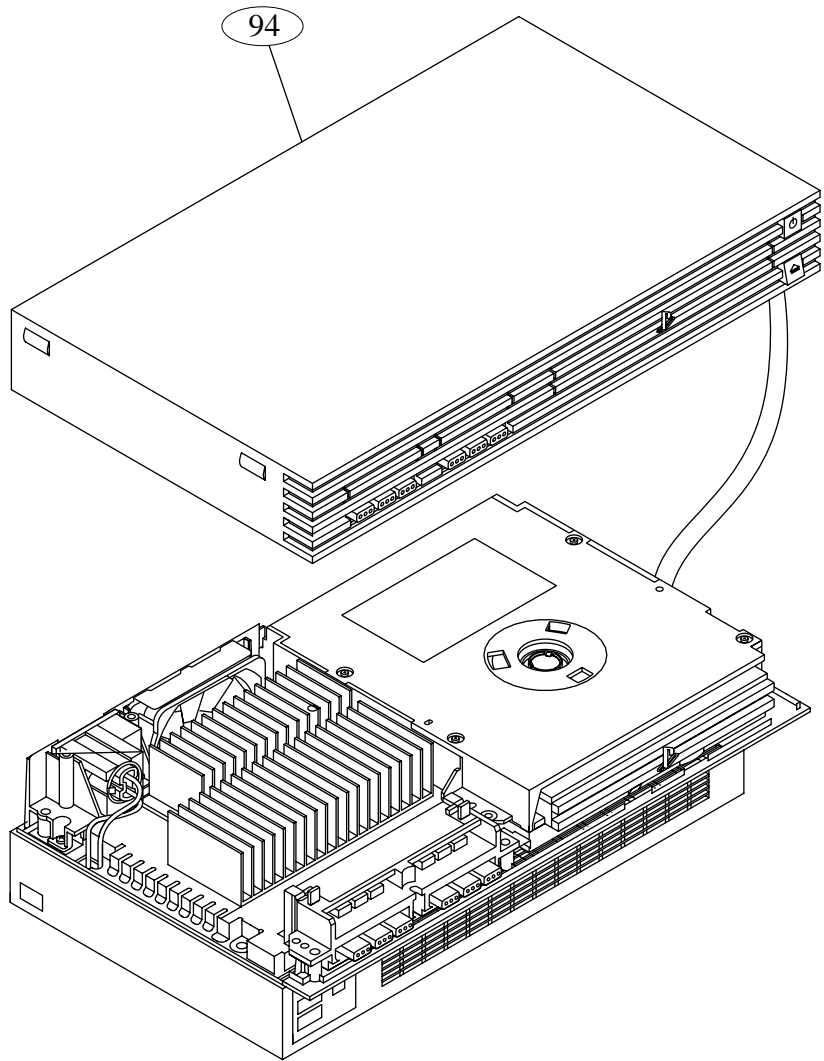

92 SWITCH BLOCK ASSY

94 UPPER COVER ASSY

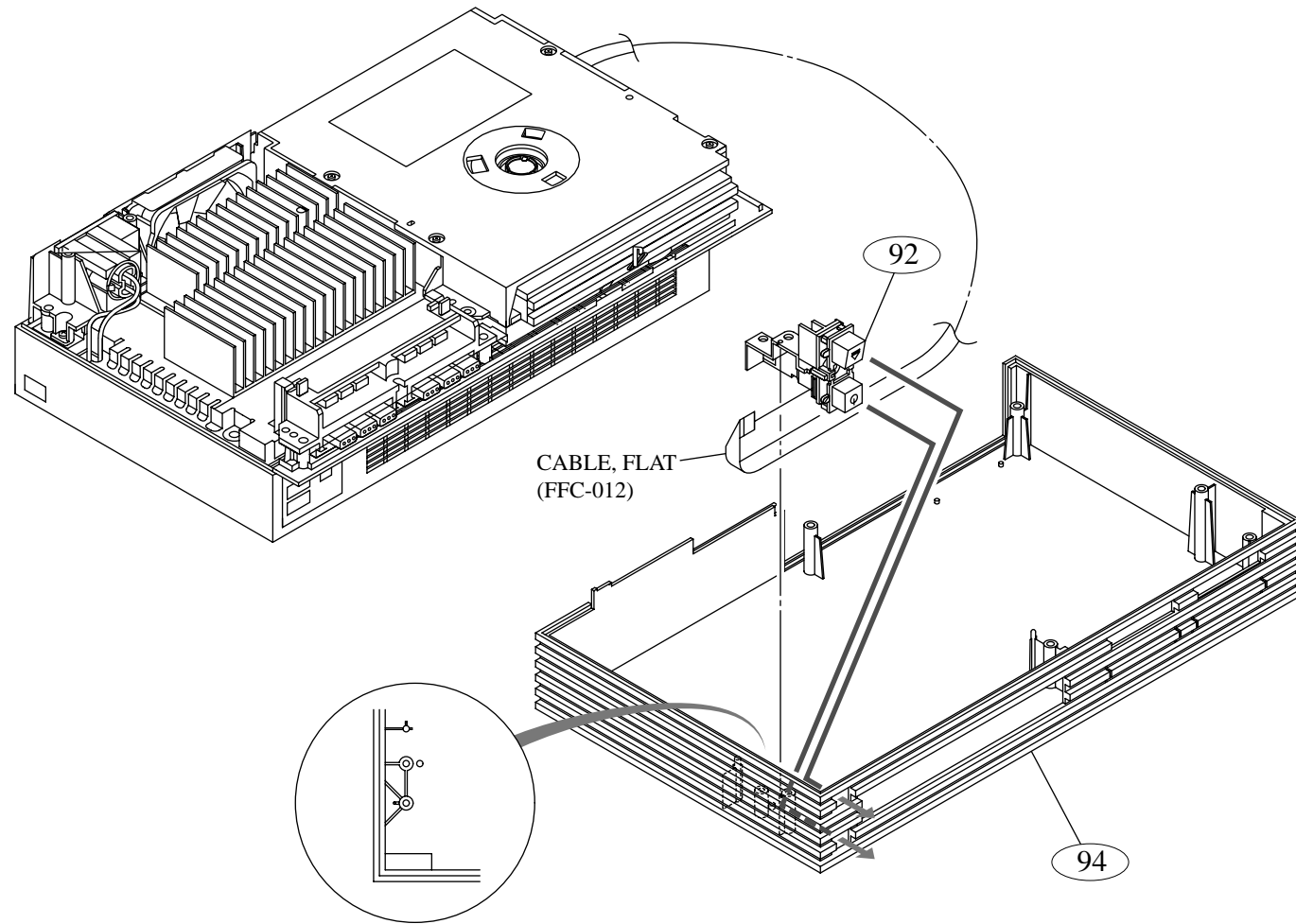

50 BUTTON, SWITCH

51 BRACKET, SWITCH

52 TPG +P 2 X 8,
TYPE 2, NON-SLIT

53 SW-358 MOUNT
SW-363 MOUNT

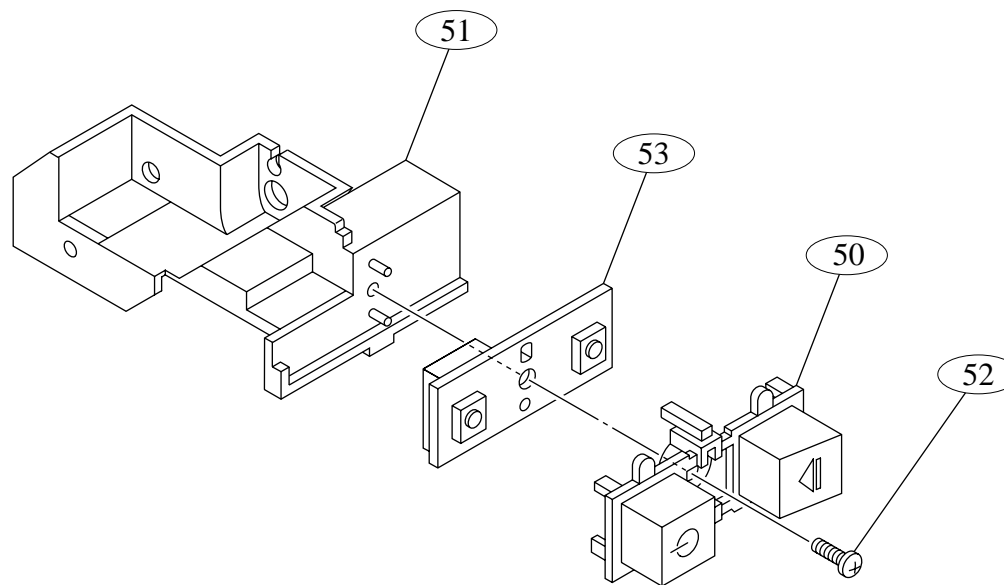

TOOLS : SCREW DRIVER (+ #0)

62 TERMINAL BOARD
(FRONT)

BV312 SCREW,
TAPPING +BV 3 x 12

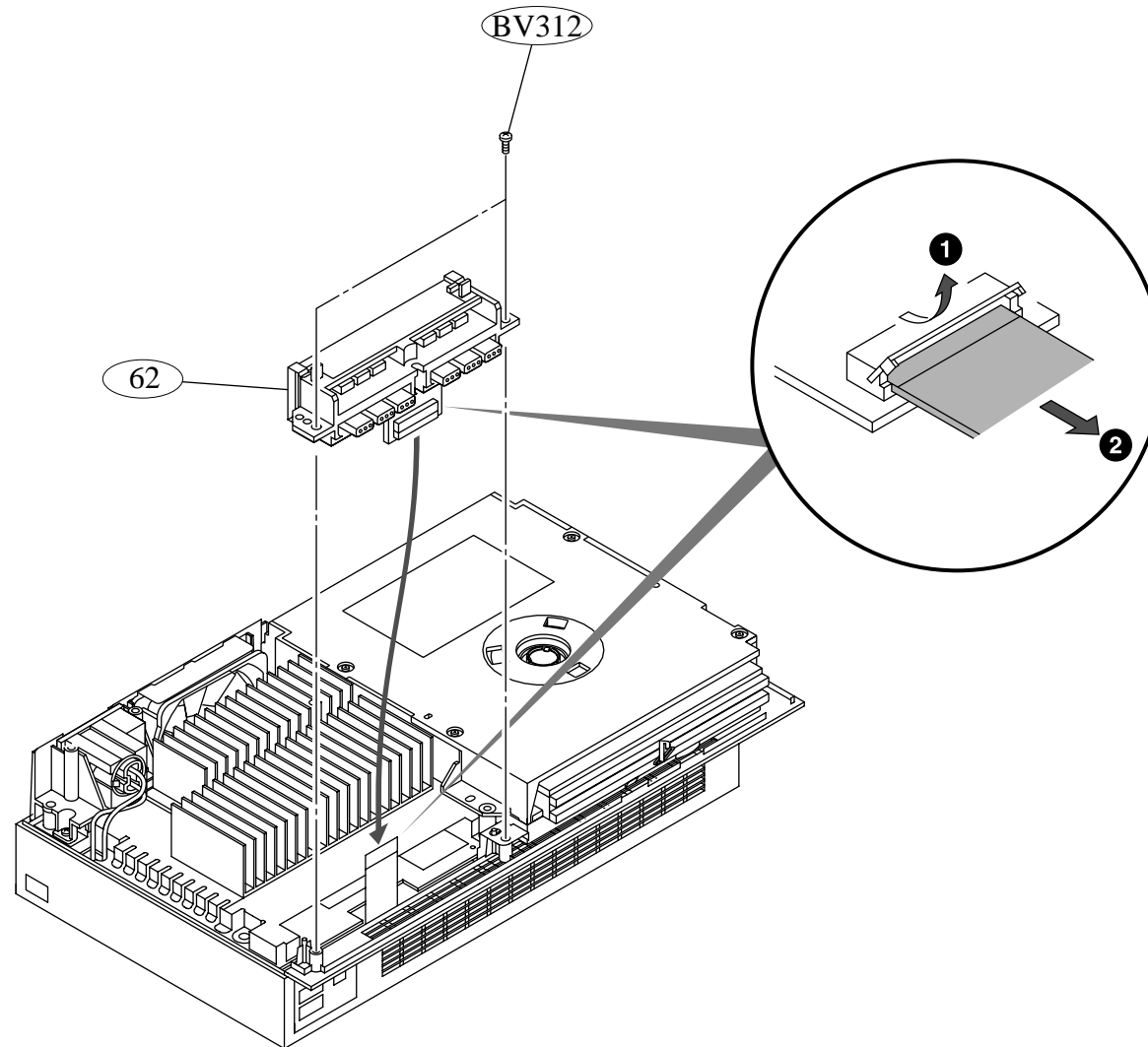

TOOLS : SCREW DRIVER (+ #3)

CAUTION

For exchanging the LOWER COVER ASSY. to new one,
Check the carved seal on surface of LOWER COVER ASSY.

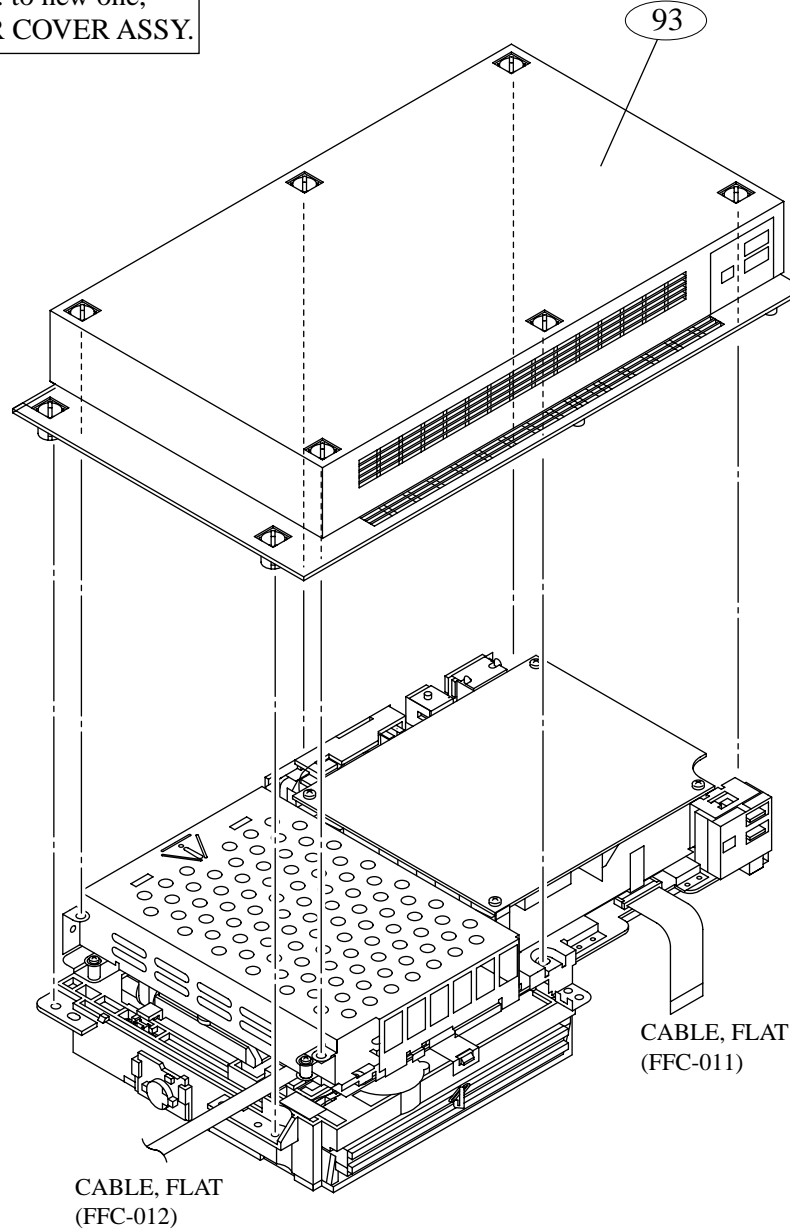

CAUTION



Use of controls or adjustments or performance of procedures other than those specified herein may result in hazardous radiation exposure.

 **60** POWER BLOCK

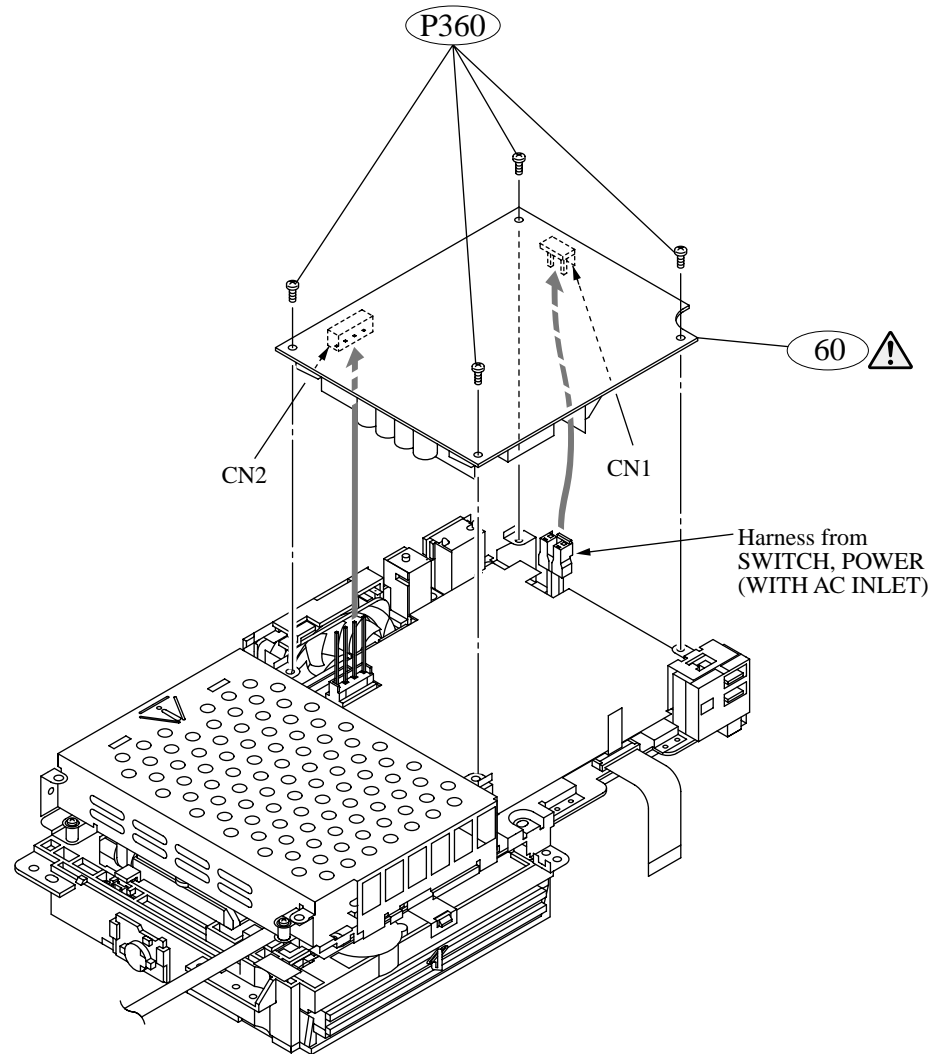
P360 SCREW +P 3 X 6



CAUTION

The components identified by mark  or dotted line with mark.  are critical for safety. Replace only with part number specified.

TOOLS : SCREW DRIVER (+ #3)

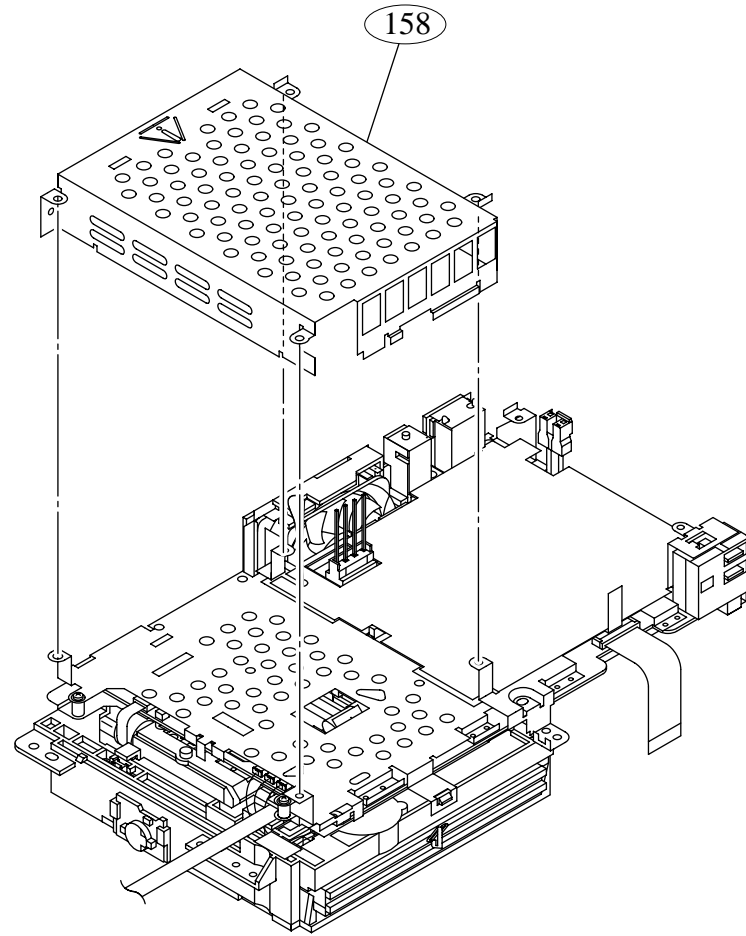

CAUTION

Never lose the fitting of INSULATING SHEET put on the SHIELD(B) when assemble the console.

CAUTION

Never lose the fitting of LABELs put on the SHIELD(B) when assemble the console.

⚠ (157) SHEET, INSULATING

⚠ (160) LABEL, CUTION, BARRIER for SCPH-30001

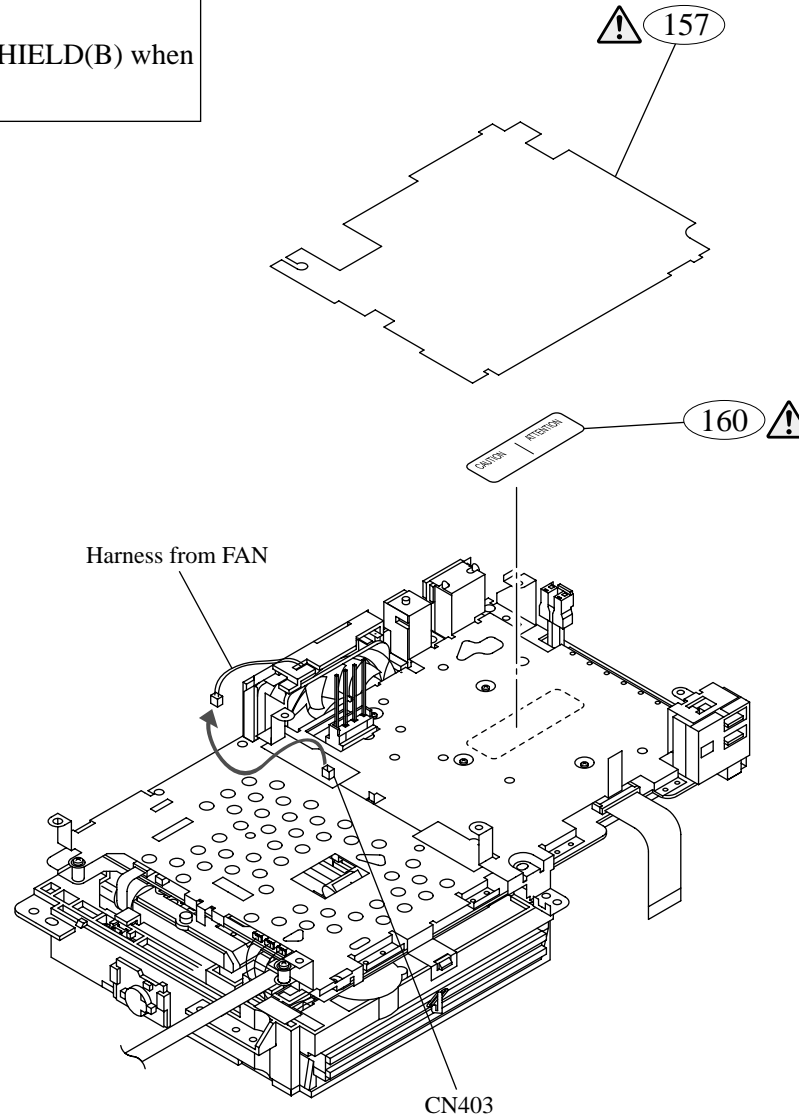

CAUTION

The components identified by mark ⚠ or dotted line with mark. ⚠ are critical for safety. Replace only with part number specified.

⚠ 64 SWITCH, POWER
(WITH AC INLET)

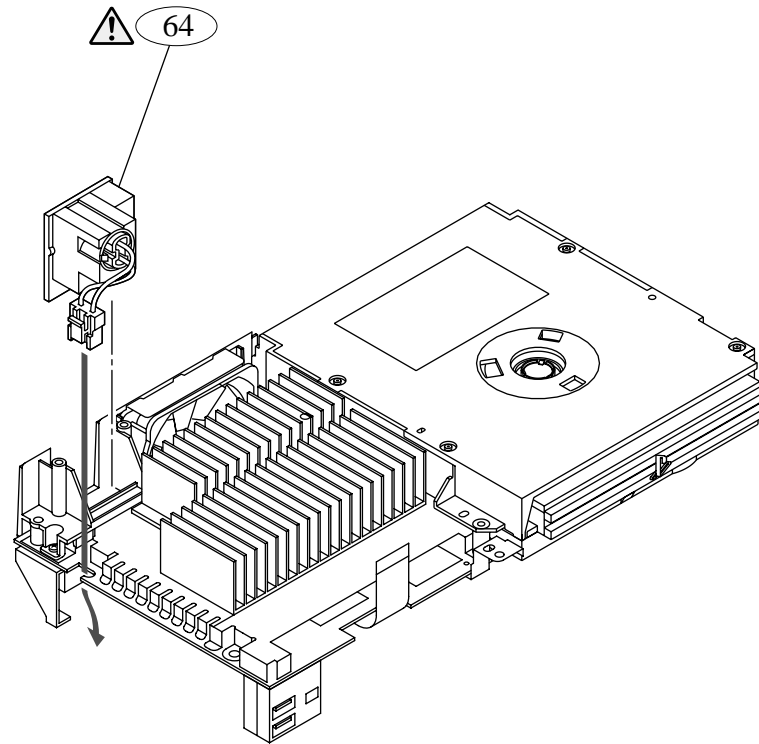

CAUTION

The components identified by mark ⚠ or dotted line with mark. ⚠ are critical for safety. Replace only with part number specified.

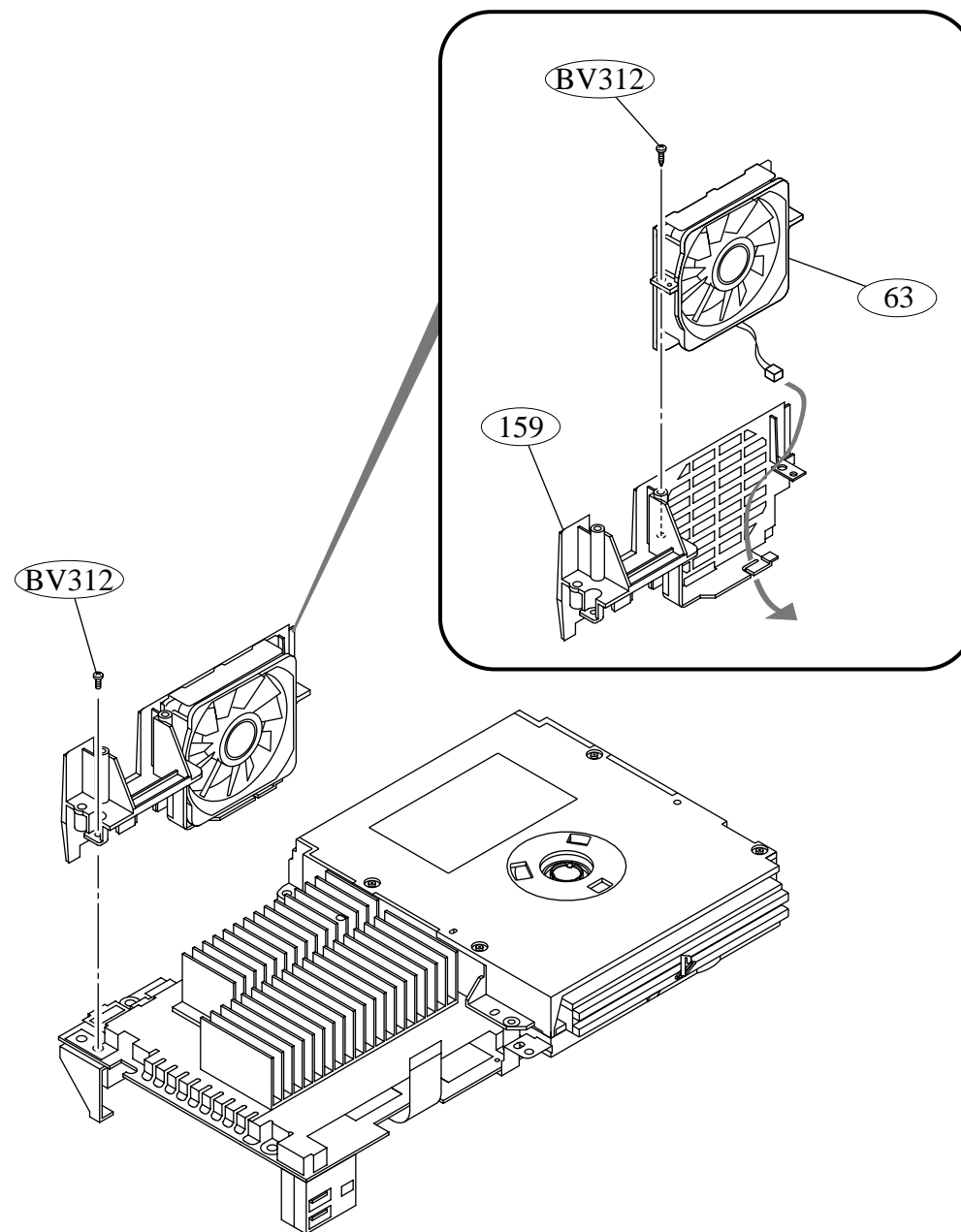

63 DC. FAN

159 PANEL, REAR

BV312 SCREW, TAPPING
+BV 3 X 12

TOOLS : SCREW DRIVER (+ #3)

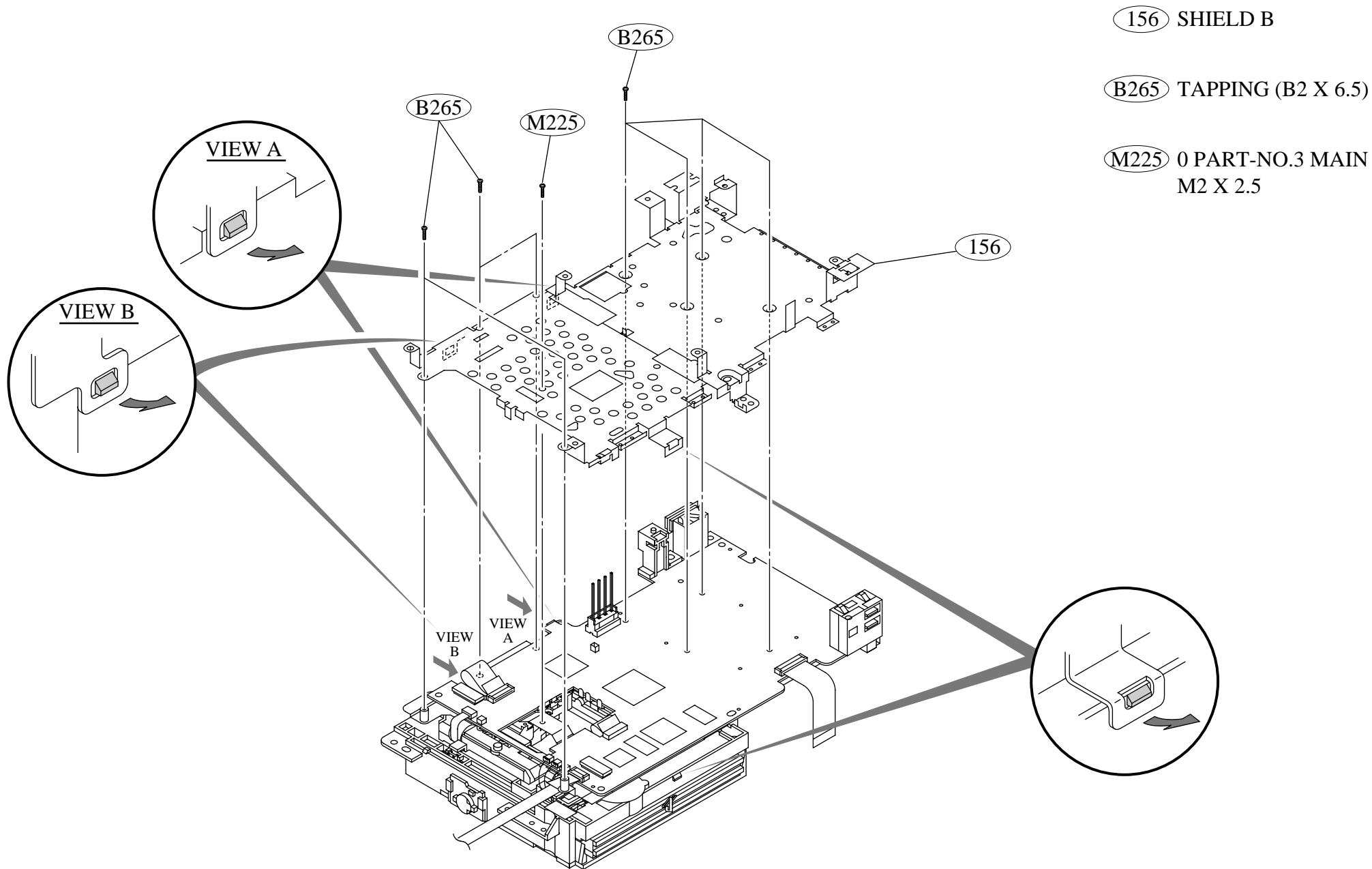

TOOLS : SCREW DRIVER (+ #0)

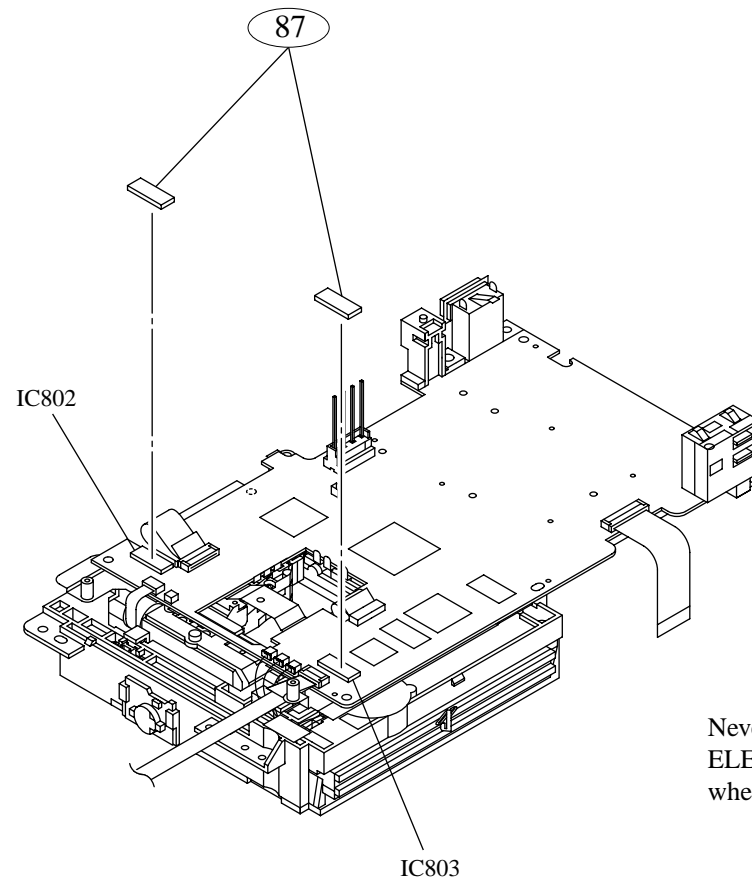

Never lose the fitting of SHEET(DRIVER),
ELECTRIC HEAT put on the IC802 and IC803
when assemble the console.

151 CABLE, FLAT (FFC-011)

152 CABLE, FLAT (FFC-012)

153 HARNESS (HS-059)

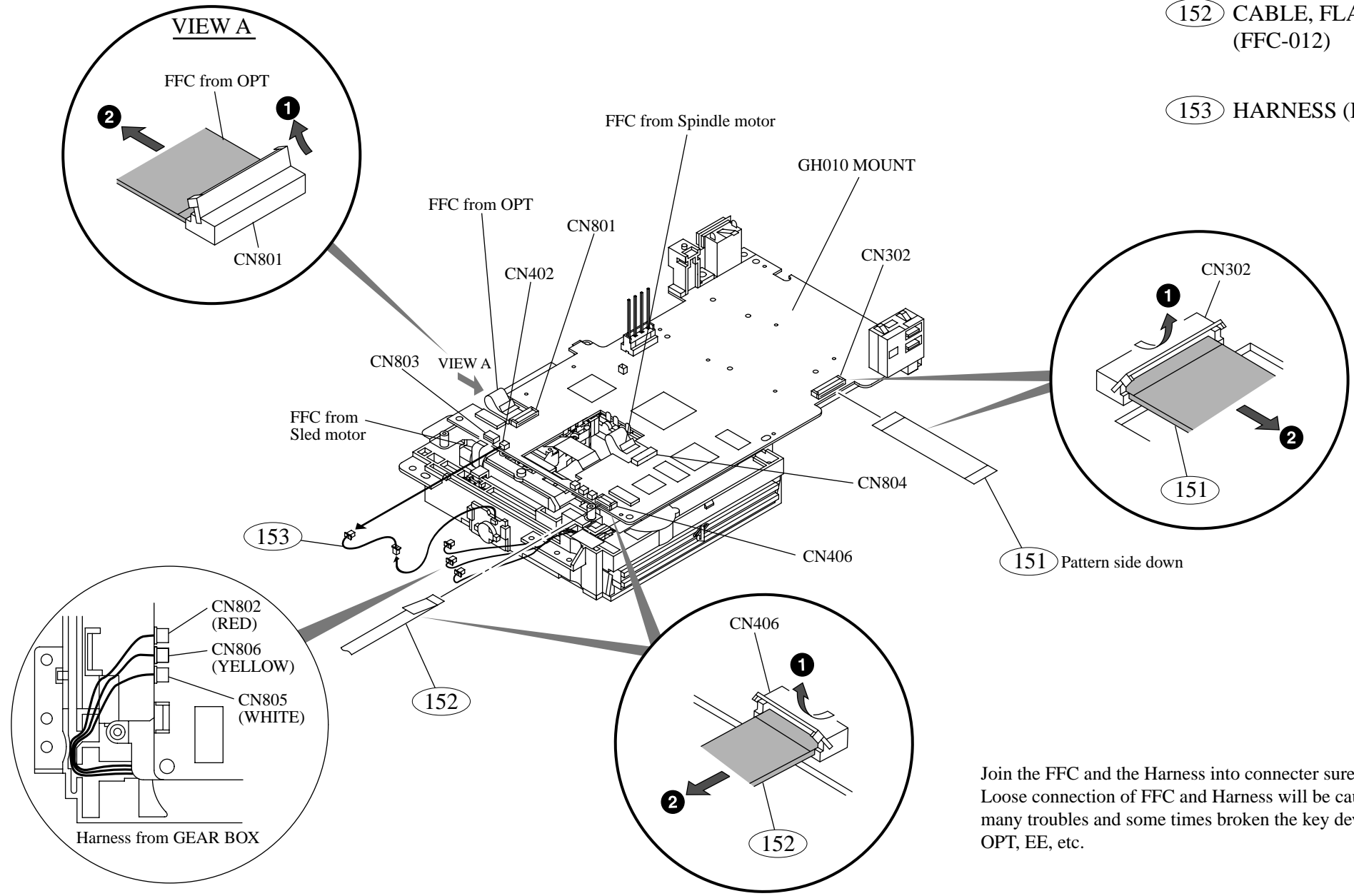

Join the FFC and the Harness into connector sureiy,
Loose connection of FFC and Harness will be caused the
many troubles and some times broken the key device like
OPT, EE, etc.

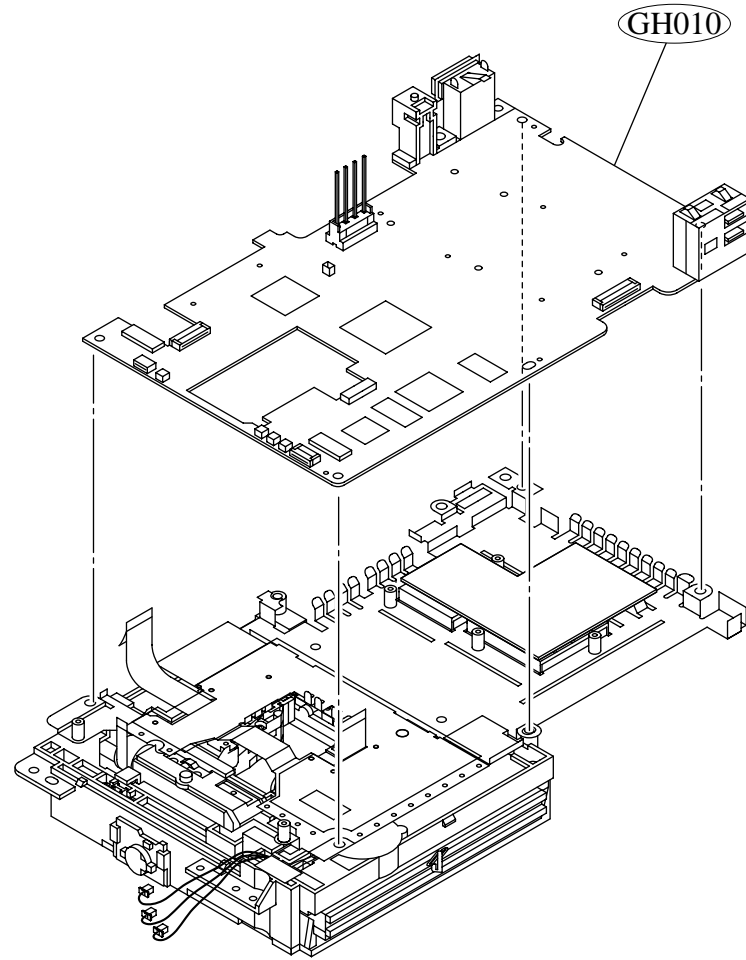

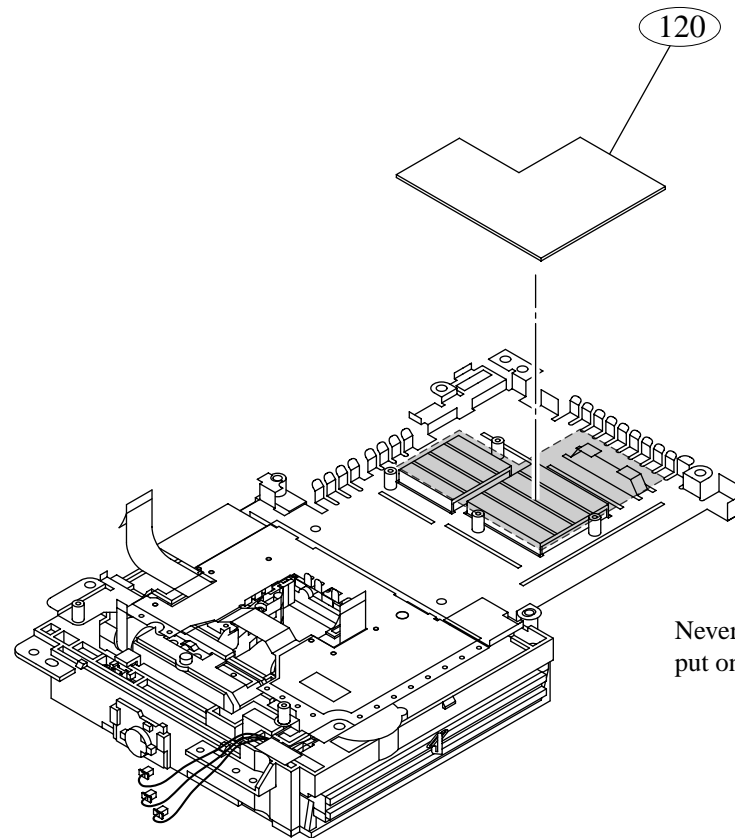

Never lose the fitting SHEET(A) ELECTRIC HEAT
put on SHIELD(A) ASSY. when assemble the console.

CAUTION

Don't touch the OPTICAL DEVICE not to broken it.

97. SHIELD (A) ASSY

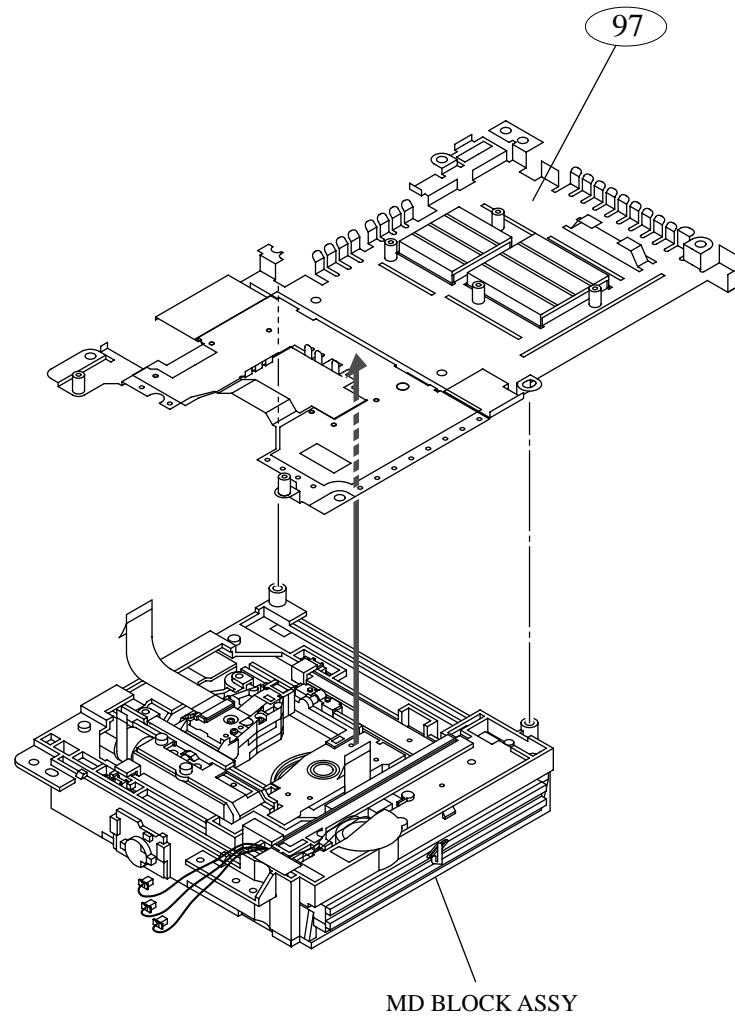

CAUTION



For dumping the consumed CR2032 Lithium battery,
Obey your county law Standard procedures.

 **61** BATTERY, LITHIUM
(CR2032 TYPE)

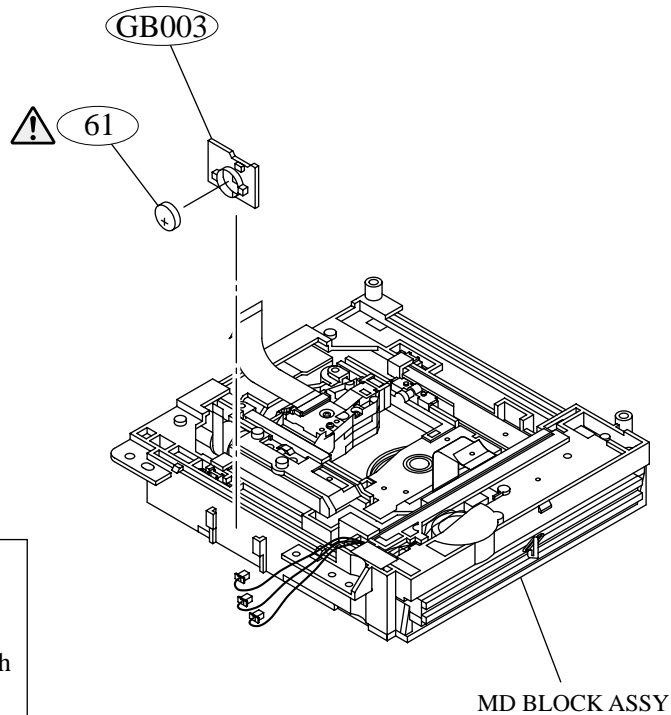
GB003 GB-003/-004 MOUNT



CAUTION

The components identified by mark  or dotted line with mark.  are critical for safety. Replace only with part number specified.

BACK

CAUTION

PULLEY BRACKET change to new one by repaier LABEL has to put on new PULLEY BRACKET due to in your country law and standart procedure for safty.

91 MD BLOCK ASSY

⚠ 103 LABEL, CAUTION

⚠ 104 LABEL, LASER CAUTION

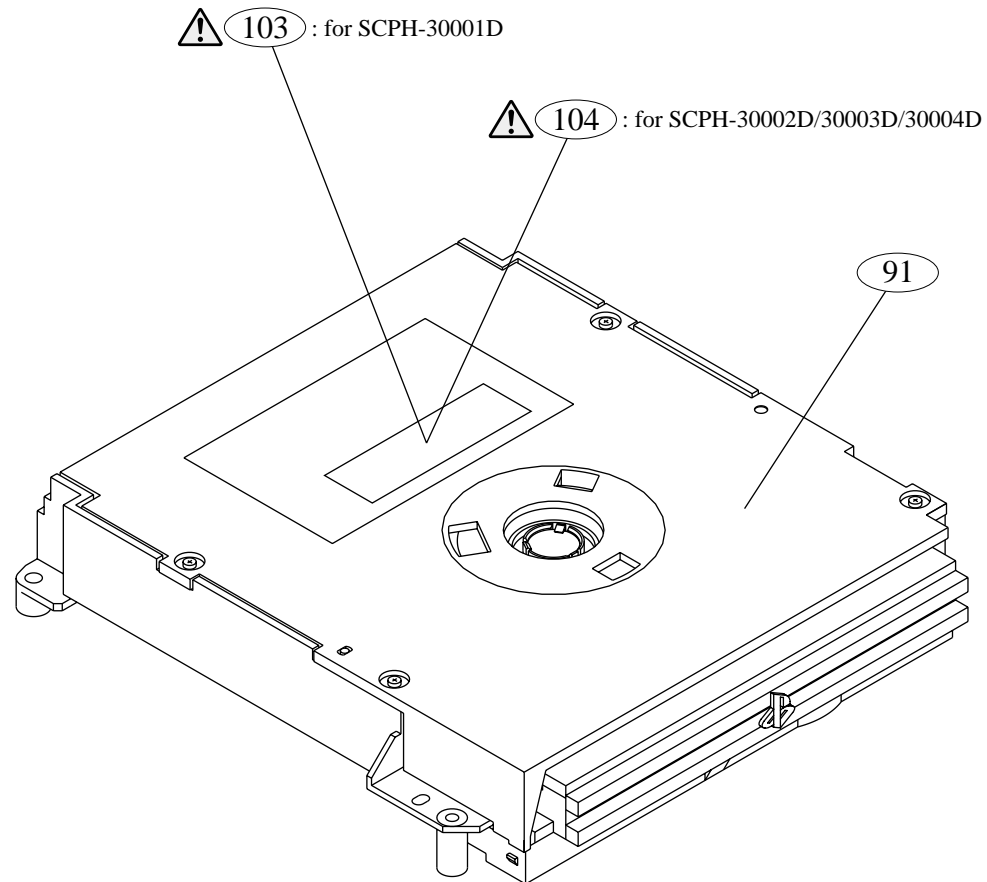

CAUTION

Don't touch the place surrounded square shown figure when tighten screws.

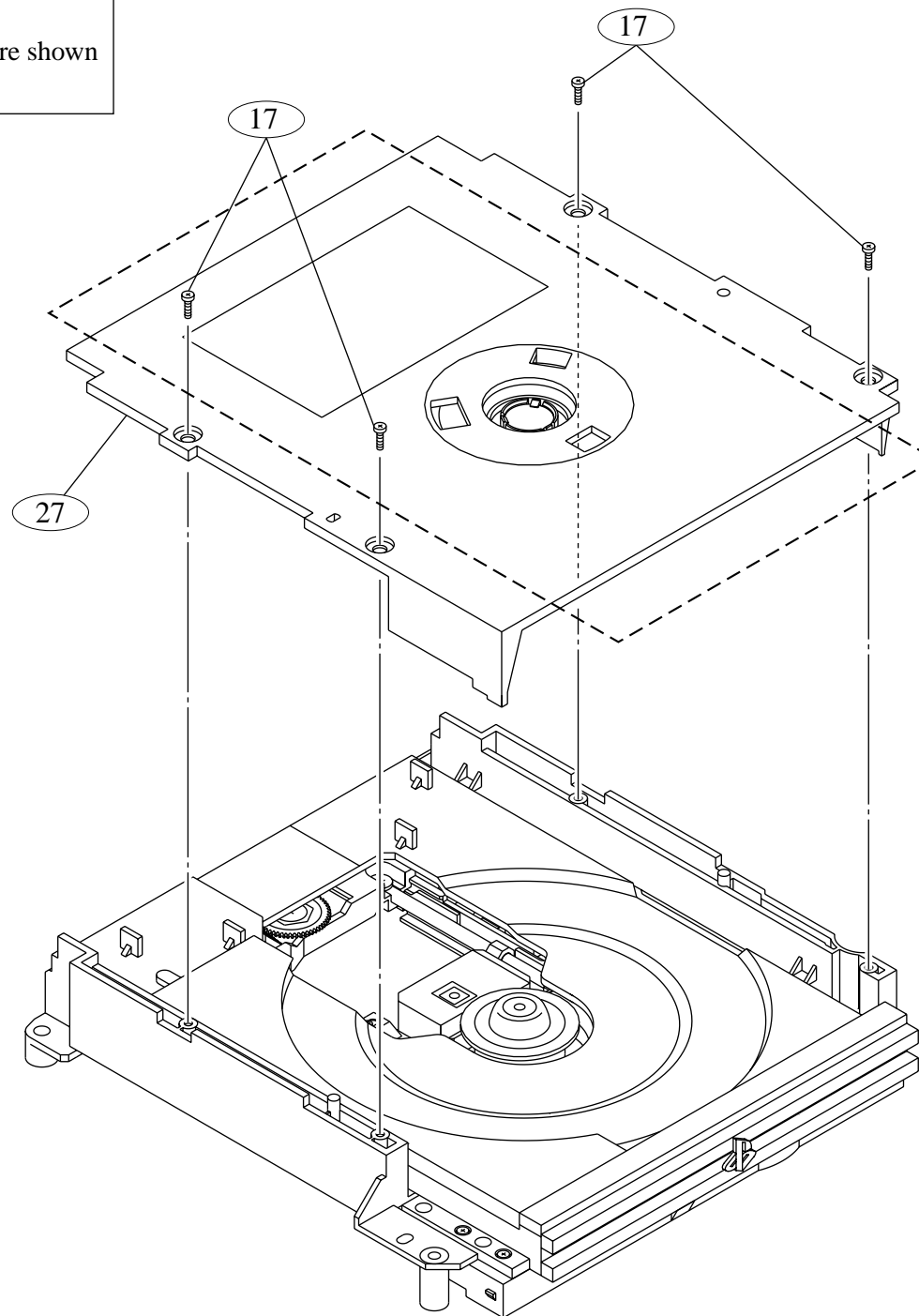

17 TAPPING (B2 X 6.5)

27 PULLEY,
BRACKET ASSY

TOOLS : SCREW DRIVER (+ #0)

17 TAPPING (B2 X 6.5)

28 TRAY ASSY

95 PLATE ASSY,
ORNAMENTAL

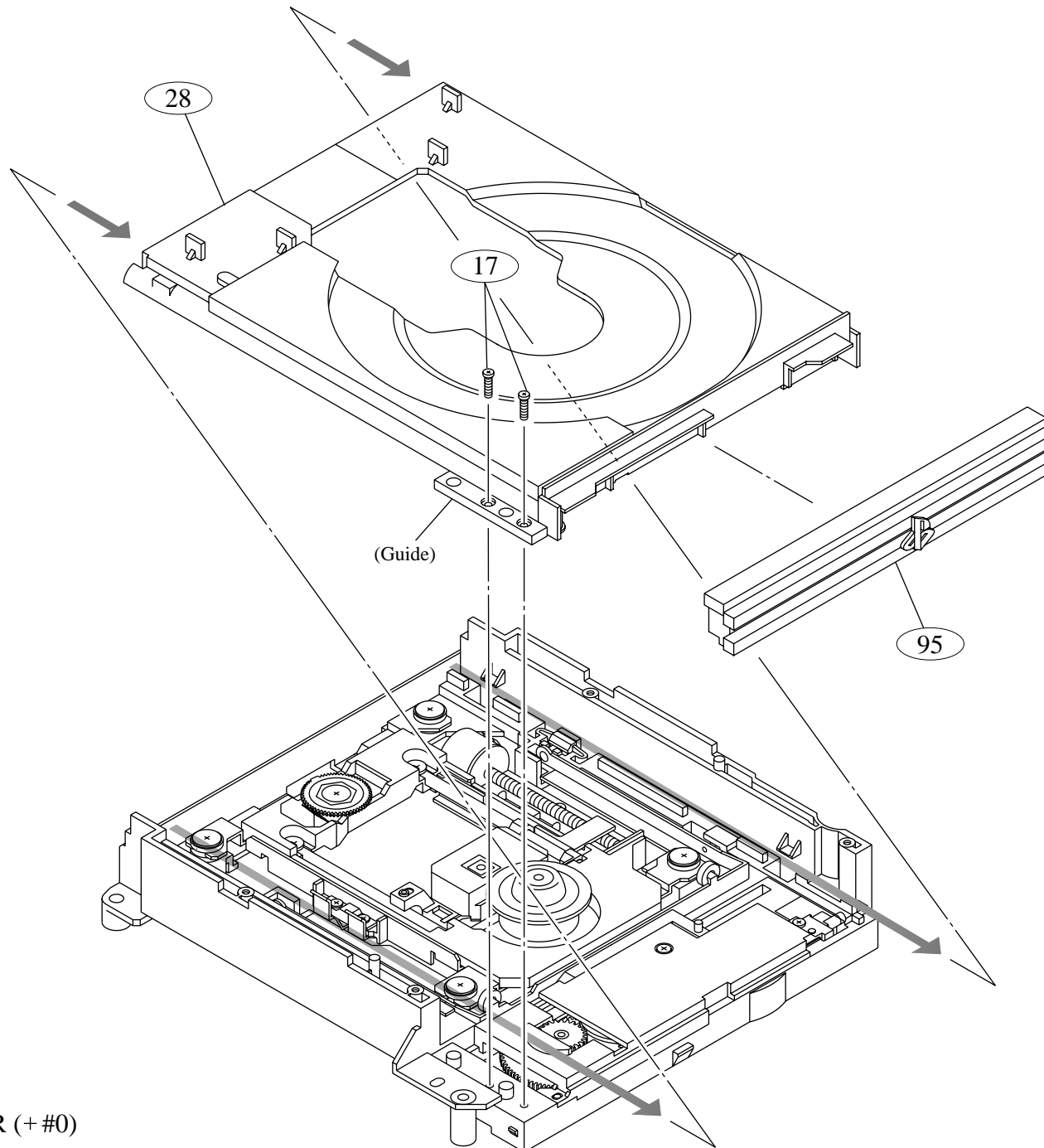

TOOLS : SCREW DRIVER (+ #0)

5 SCREW (B2 X 6.5),
SHAFT RETAINER

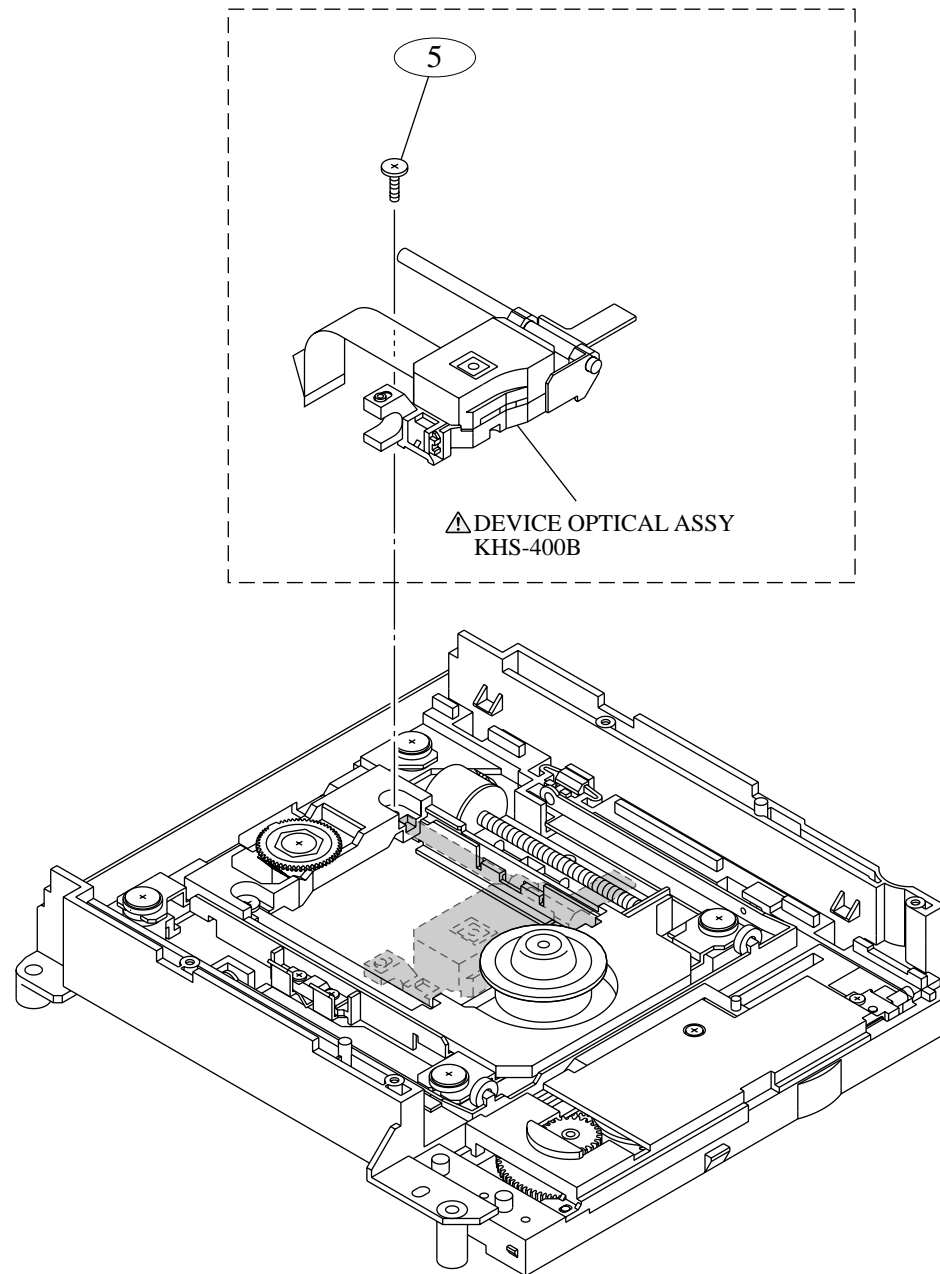

TOOLS : SCREW DRIVER (+ #0)

TOP SIDE VIEW

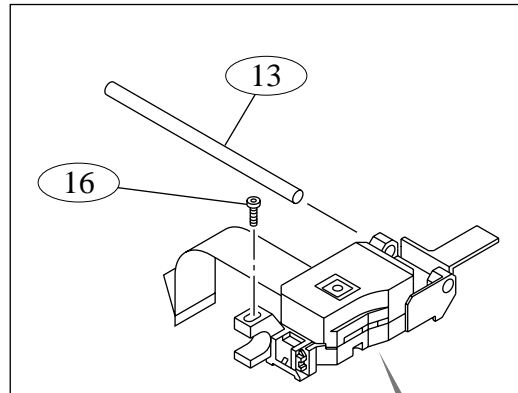

④ PWB, FLEXIBLE

⑬ SHAFT, MAIN

⑭ RACK

⑯ SCREW, SKEW

⑳ 0 PLATE 3 MAIN
M2 X 3.2

BOTTOM SIDE VIEW

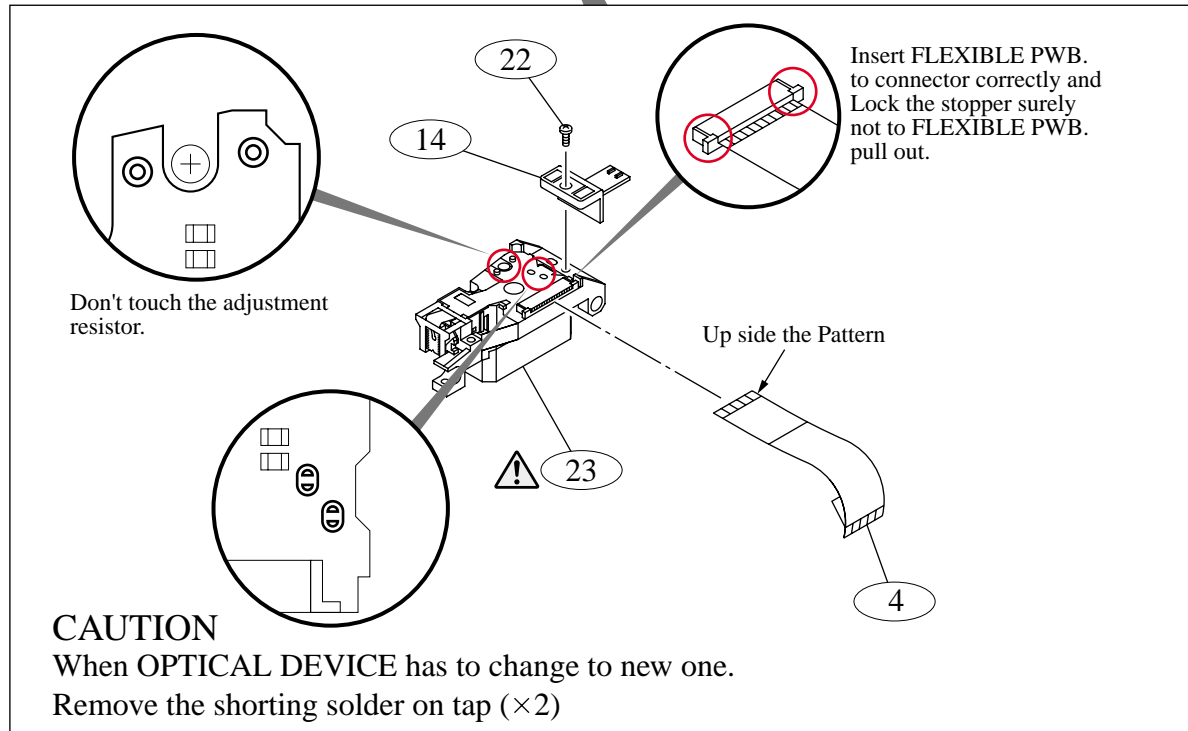

⚠ ㉓ DEVICE, OPTICAL
KHS-400B

TOOLS : SCREW DRIVER (+ #0)
HEXAGRAM SCREW DRIVER (T5)

32 SCREW,
CAM RETAINER

33 CAM, TILT

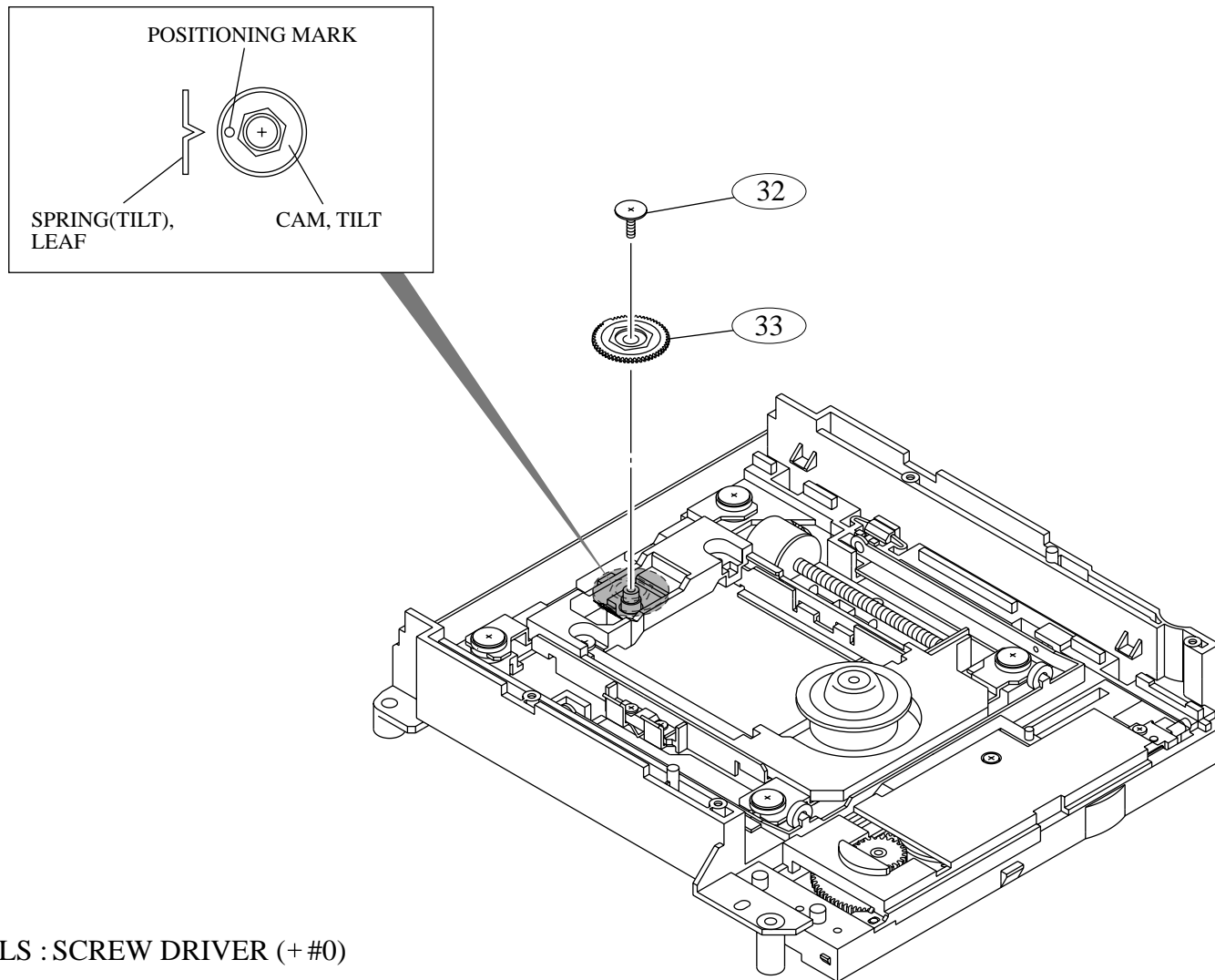

TOOLS : SCREW DRIVER (+ #0)

3 MOTOR, DC

17 TAPPING (B2 X 6.5)

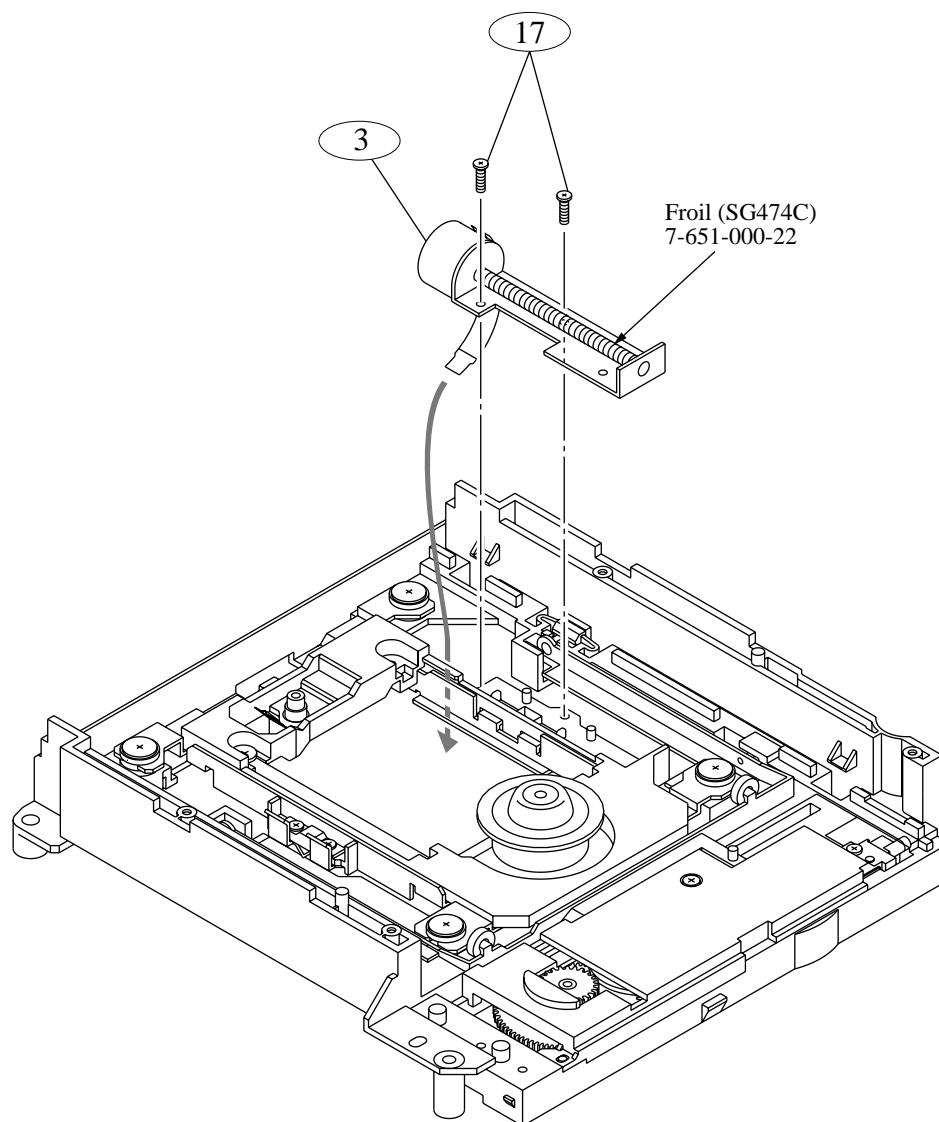

TOOLS : SCREW DRIVER (+ #0)

22 0 PLATE 3 MAIN
M2 X 3.2

35 GUIDE (L)

36 GUIDE (R)

37 SCREW, SKEW

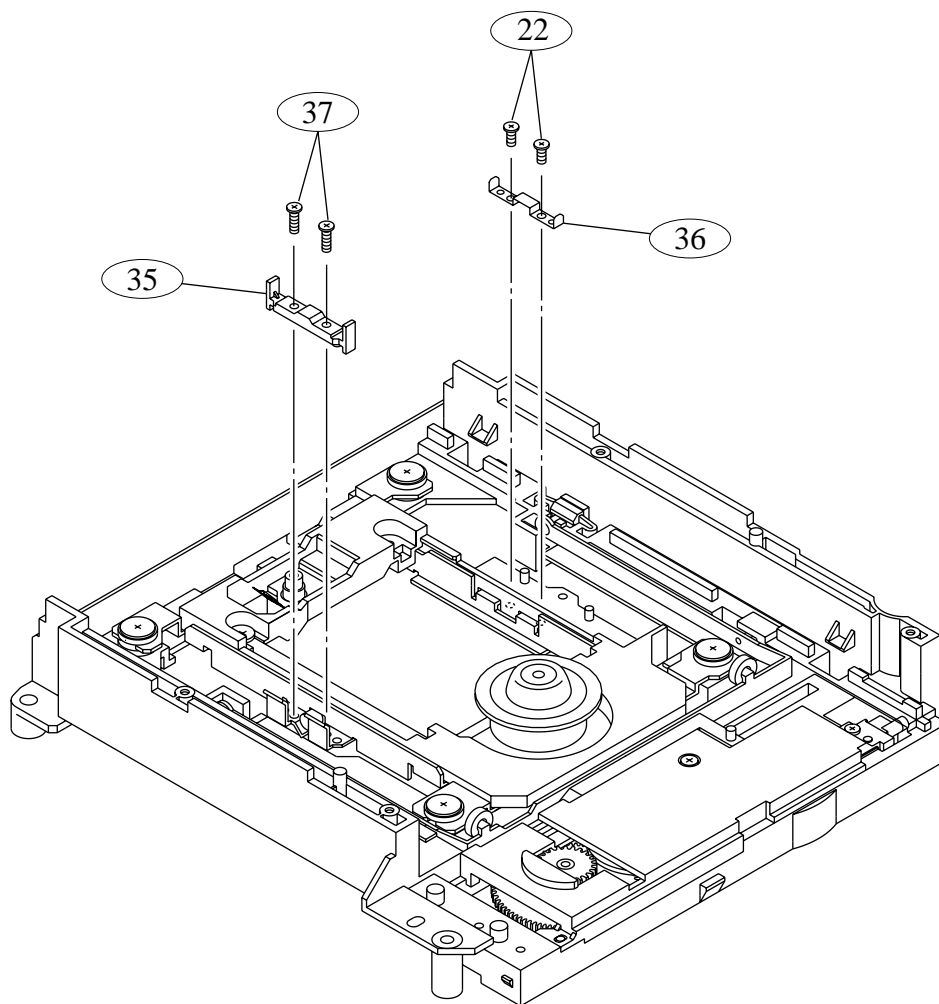

TOOLS : SCREW DRIVER (+ #0)

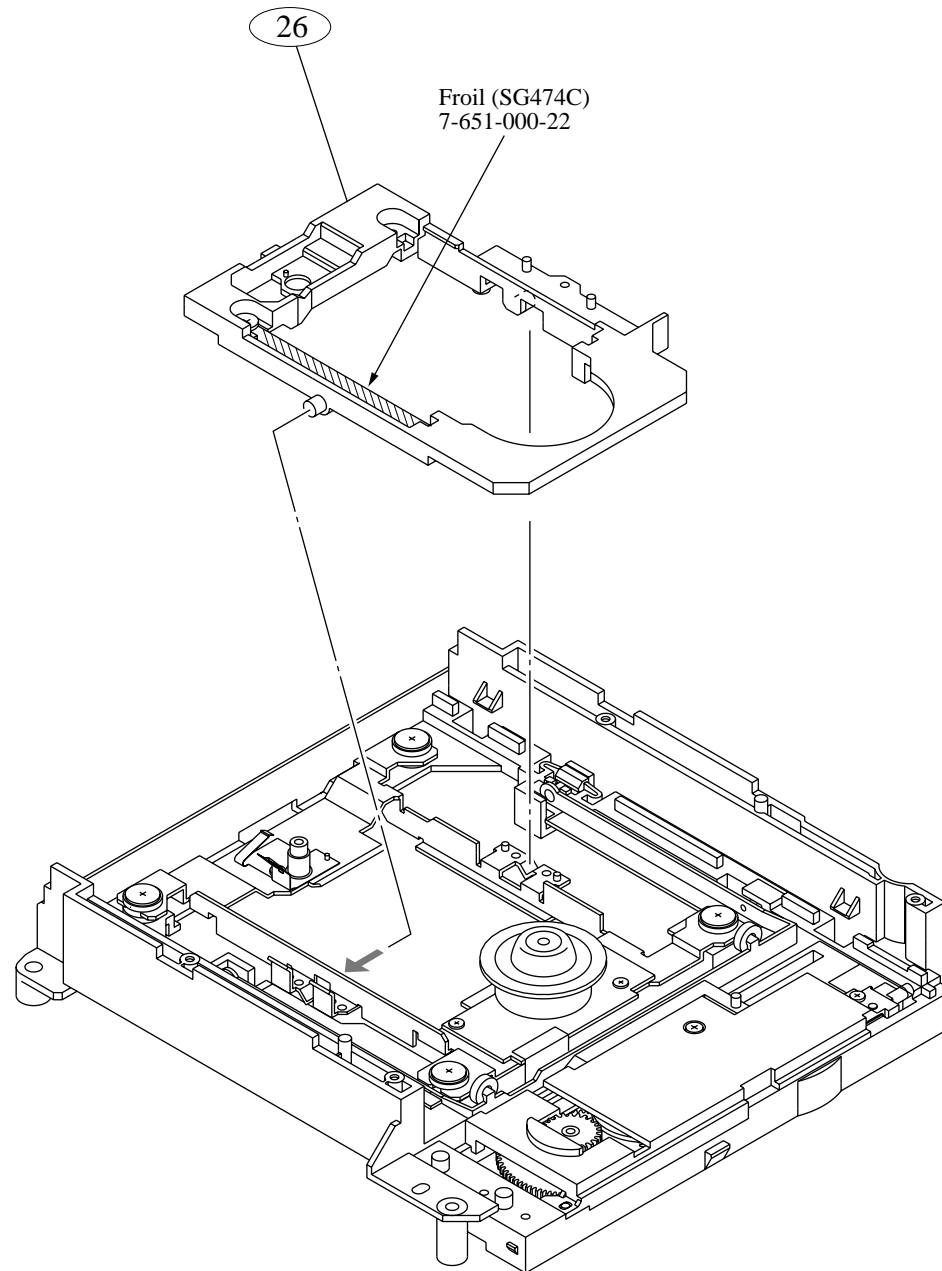

2 SPINDLE
MOTOR, DC

22 O PLATE 3 MAIN
M2 X 3.2

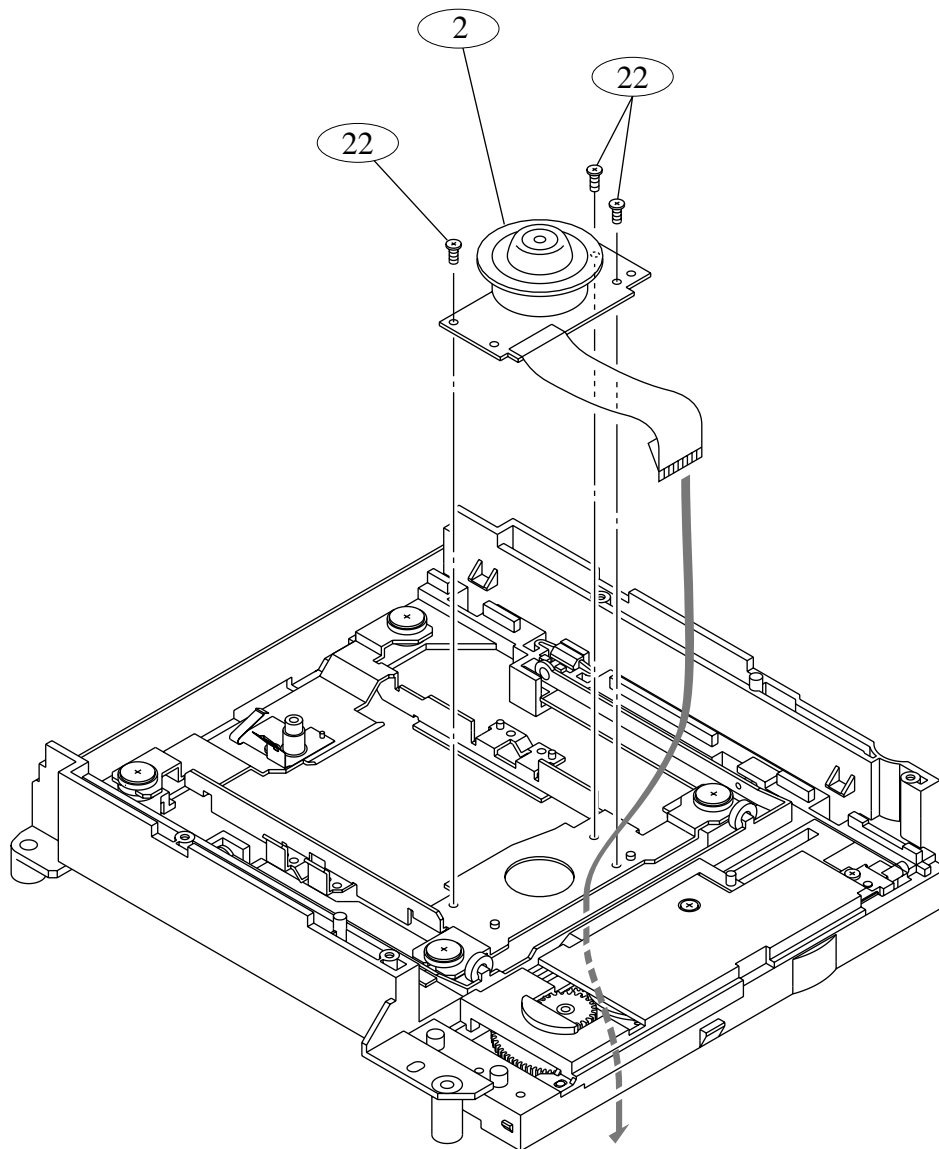

TOOLS : SCREW DRIVER (+ #0)

22 0 PLATE 3 MAIN
M2 X 3.2

34 SPRING (TILT),
LEAF

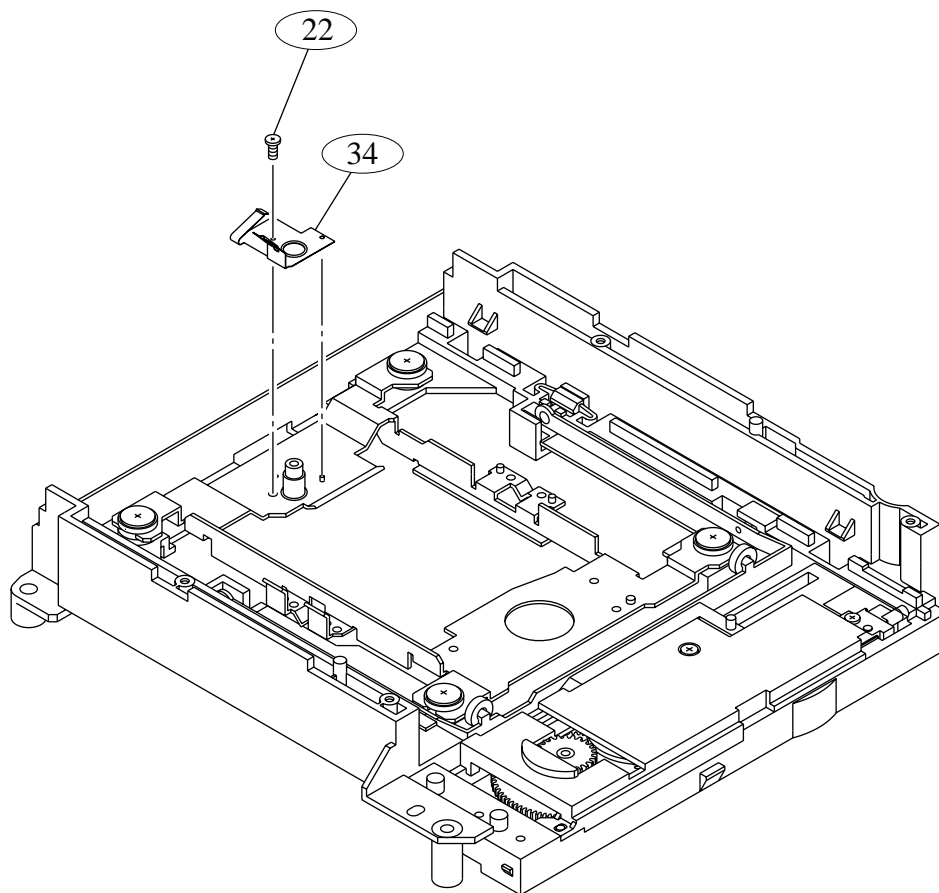

TOOLS : SCREW DRIVER (+ #0)

9 SCREW, STEP

32 SCREW (SUB), STEP

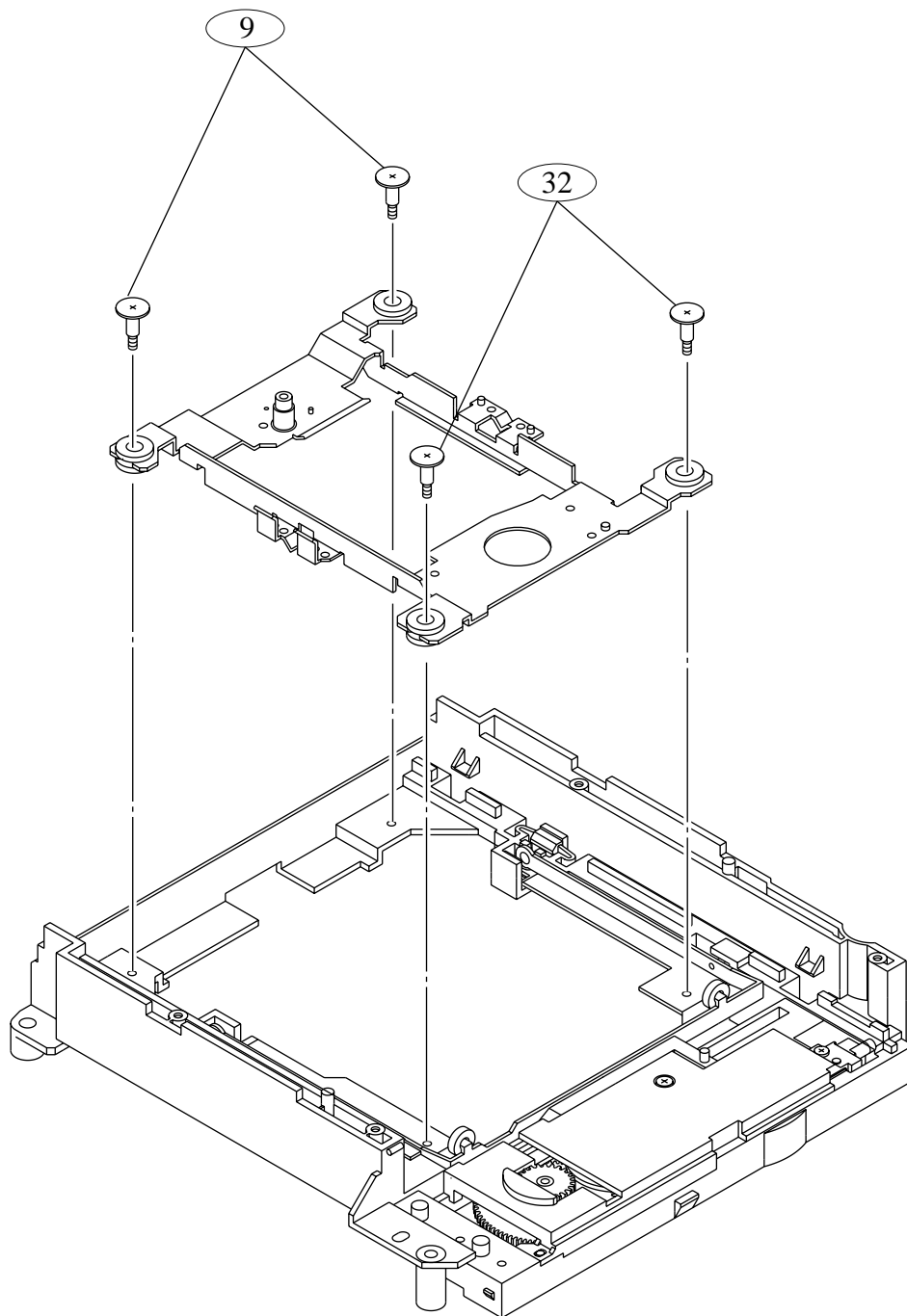

TOOLS : SCREW DRIVER (+ #0)

8 INSULATOR

10 CHASSIS ASSY,
MAIN

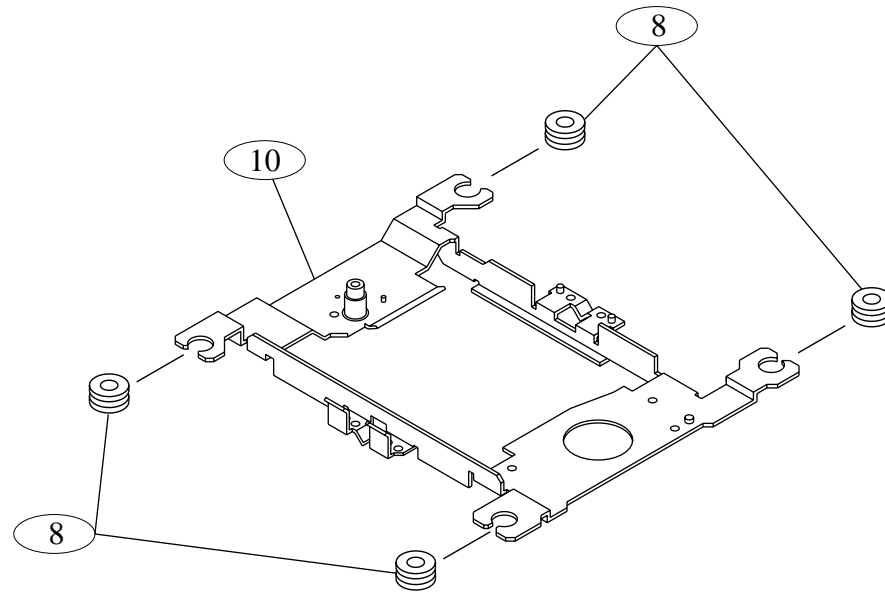

7 SUB FRAME ASSY

30 MAIN FRAME ASSY

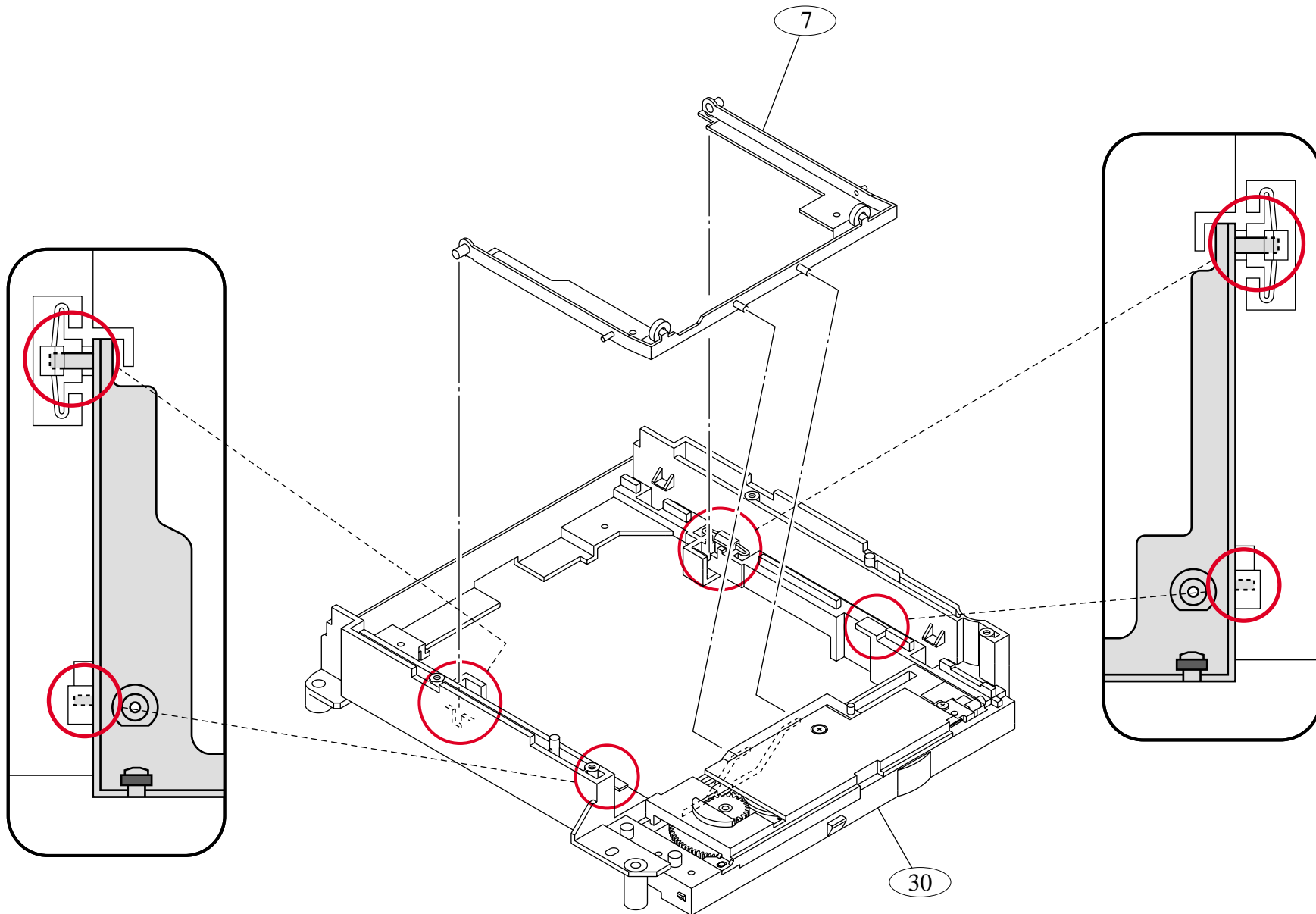

MF4 BELT, RUBBER

MF5 COVER GEAR

MF6 TAPPING (B2 X 6.5)

MF7 SWITCH LEAF

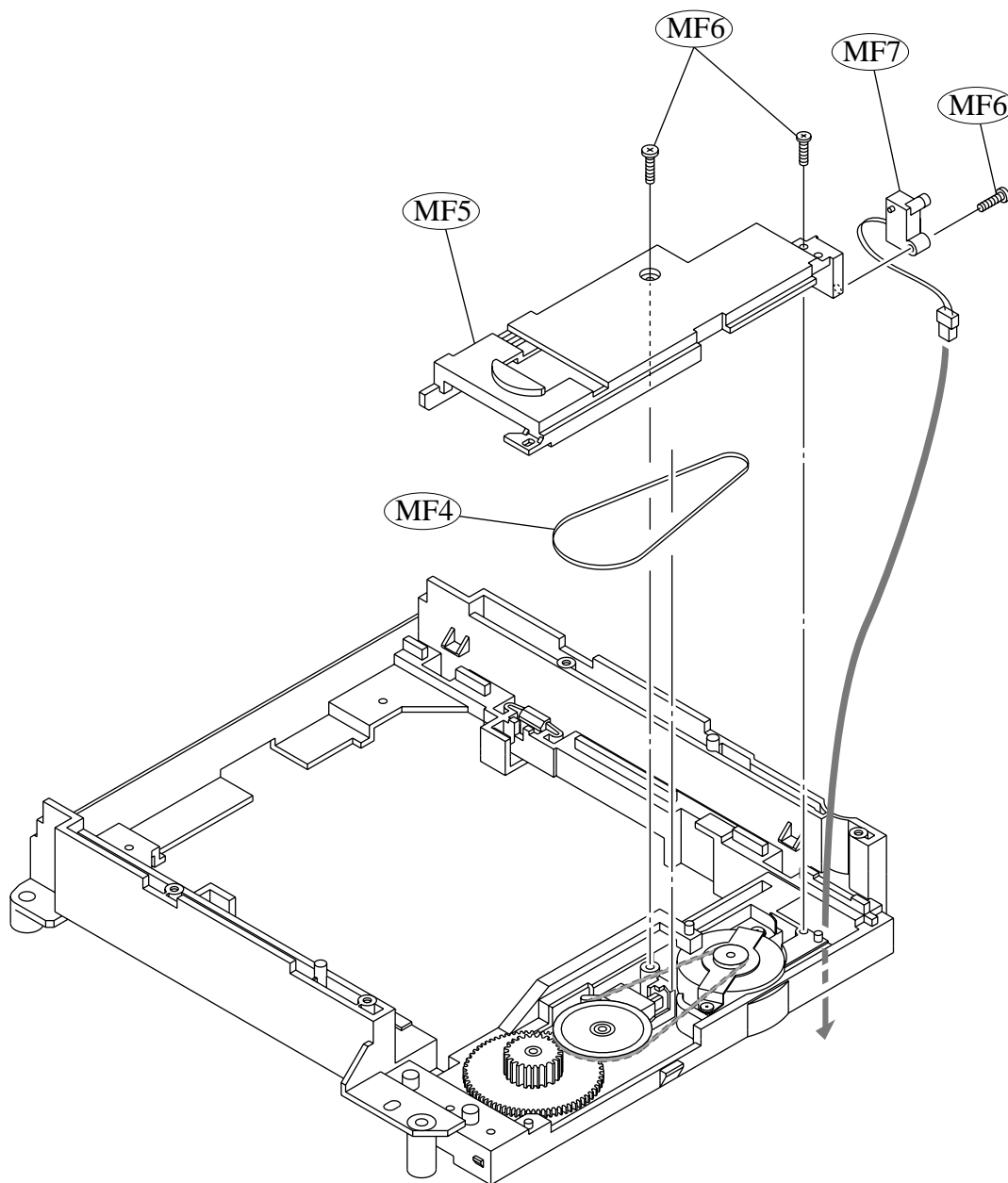

TOOLS : SCREW DRIVER (+ #0)

MF1 CAM, SLIDE

MF2 PULLEY

MF3 GEAR, DRIVING

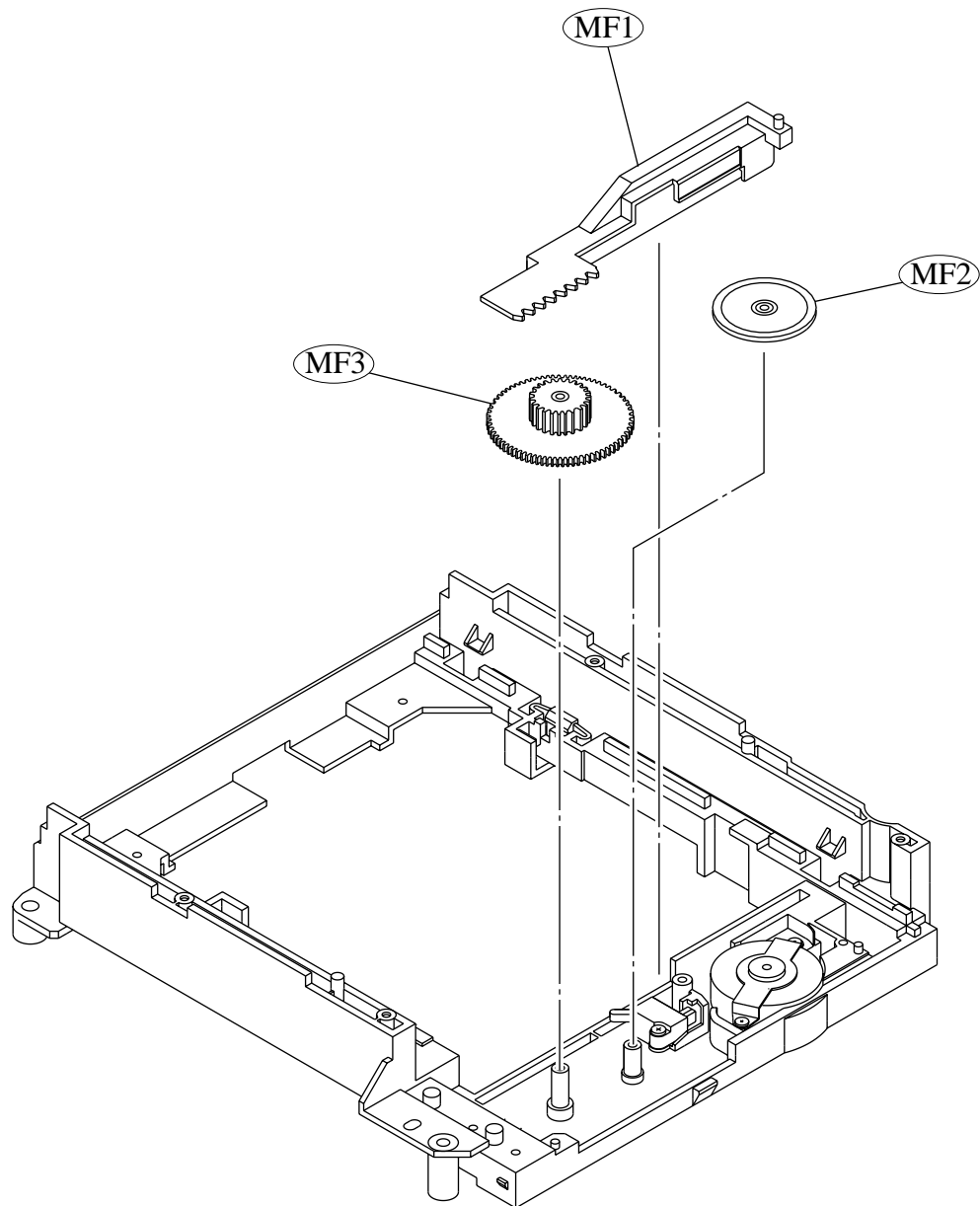

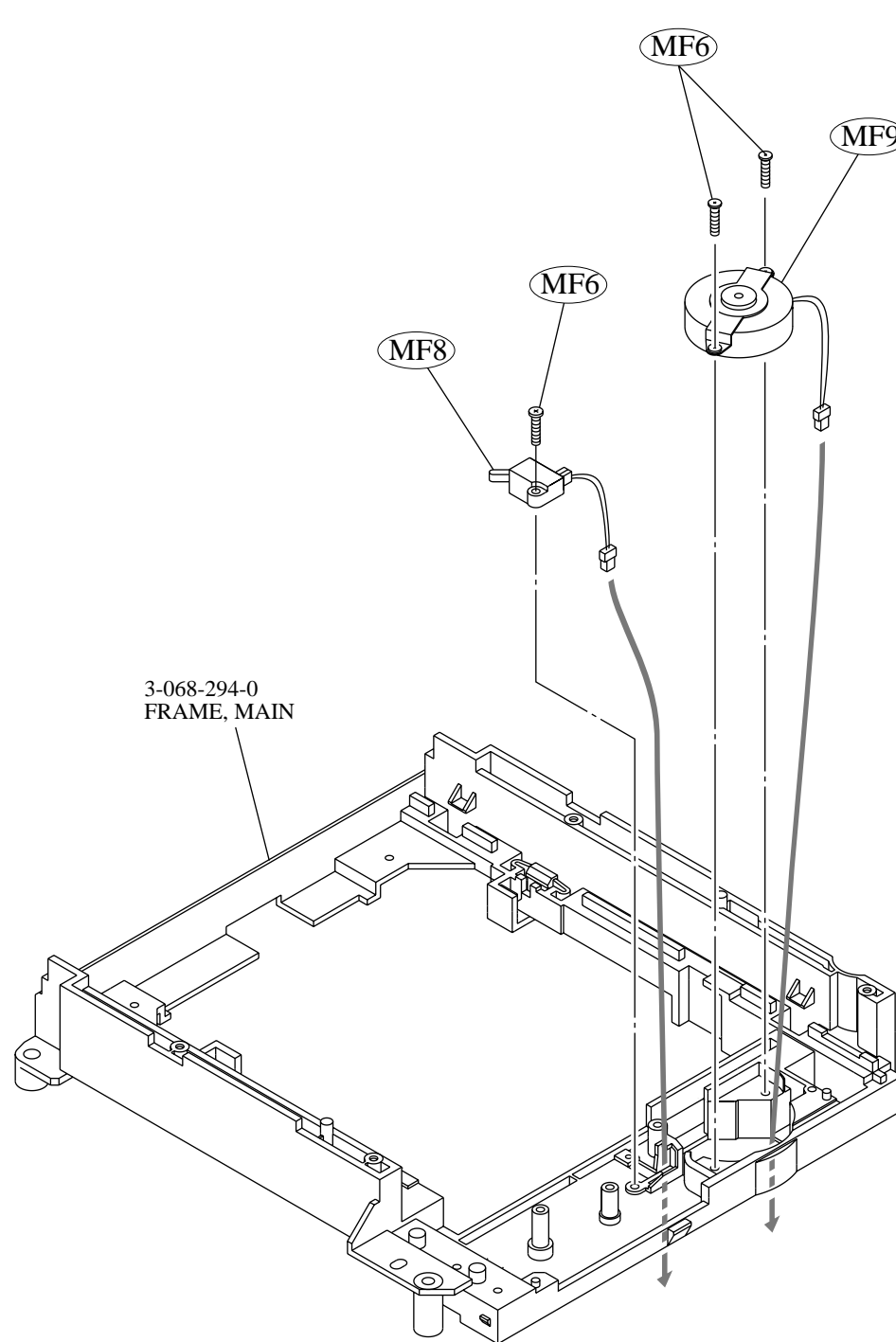

3-068-294-0
FRAME, MAIN

MF6 TAPPING (B2 X 6.5)

MF8 SWITCH LEAF

MF9 LOADING MOTOR, DC

BACK

COVER PAGE

TOOLS : SCREW DRIVER (+ #0)